

oakheart

£950 Per Month

Per Month

Fonnereau Road, Ipswich



Situated on one of Ipswich's most prestigious roads, this redecorated two-bedroom apartment offers a perfect combination of period charm and modern living. The property has just undergone full redecoration, providing a fresh, contemporary feel throughout and is presented in immaculate condition.

The accommodation comprises a spacious open-plan living

and dining area, filled with natural light and finished to a high standard, a fitted kitchen with integrated appliances, two well-proportioned bedrooms, and a bathroom.

Perfectly positioned within walking distance of Christchurch Park, the town centre, and Ipswich train station, this apartment offers exceptional convenience for commuters and professionals alike.

Additional benefits include one allocated parking, gas central heating, and secure entry access.







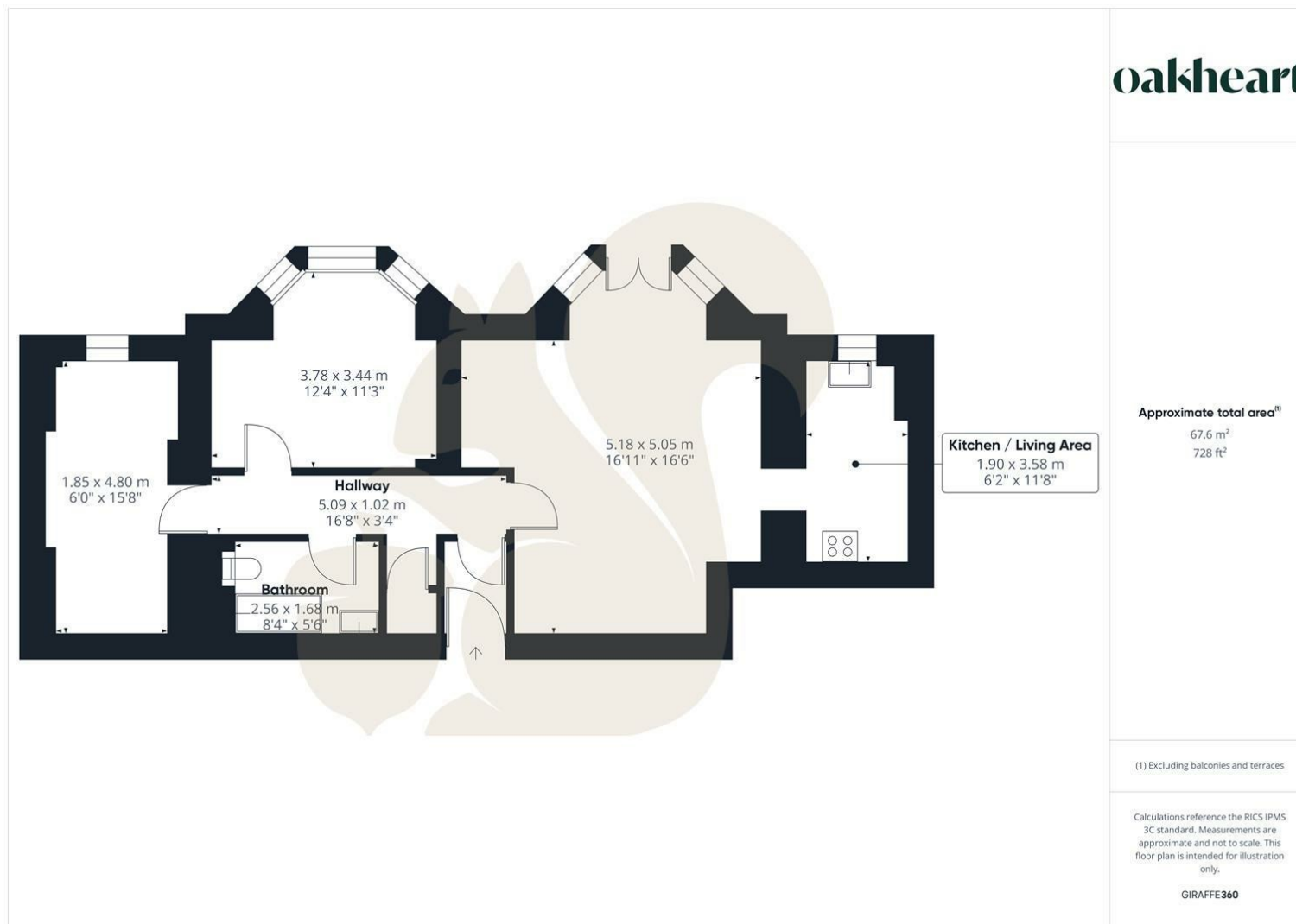

Local Authority:
Ipswich Borough Council

Tenure:

Council Tax Band:
A

Energy Efficiency Rating

	Current	Potential
Very energy efficient - lower running costs		
(92 plus) A		
(81-91) B		
(69-80) C		78
(55-68) D	67	
(39-54) E		
(21-38) F		
(1-20) G		
Not energy efficient - higher running costs		
England & Wales	EU Directive 2002/91/EC	

Agents Note: Whilst every care has been taken to prepare these particulars, they are for guidance purposes only. All measurements are approximate and are for general guidance purposes only and whilst every care has been taken to ensure their accuracy, they should not be relied upon.

Oakheart Ipswich Lettings
01473 251907
suffolklettings@oakheart.co.uk
12 Upper Brook Street, Ipswich, Suffolk, IP4 1EF

oakheart