



Edna Road, SW20

£825,000

An opportunity to purchase a well presented family home in the desirable "Apostles" area of Raynes Park. The property has three double bedrooms, two bathroom and is offered to the market with no forward chain.

Edna Road Is just a short walk from both Wimbledon Chase and Raynes Park Stations with its quick connections in to London. A multitude of shops, restaurants, pubs and a Waitrose also just a short walk away.

Features

- Edwardian Apostle House
- Three Double Bedrooms
- Two Bathrooms
- Low Maintenance Garden
- Wimbledon Chase Catchment
- No Onward Chain

Edna Road, London, SW20

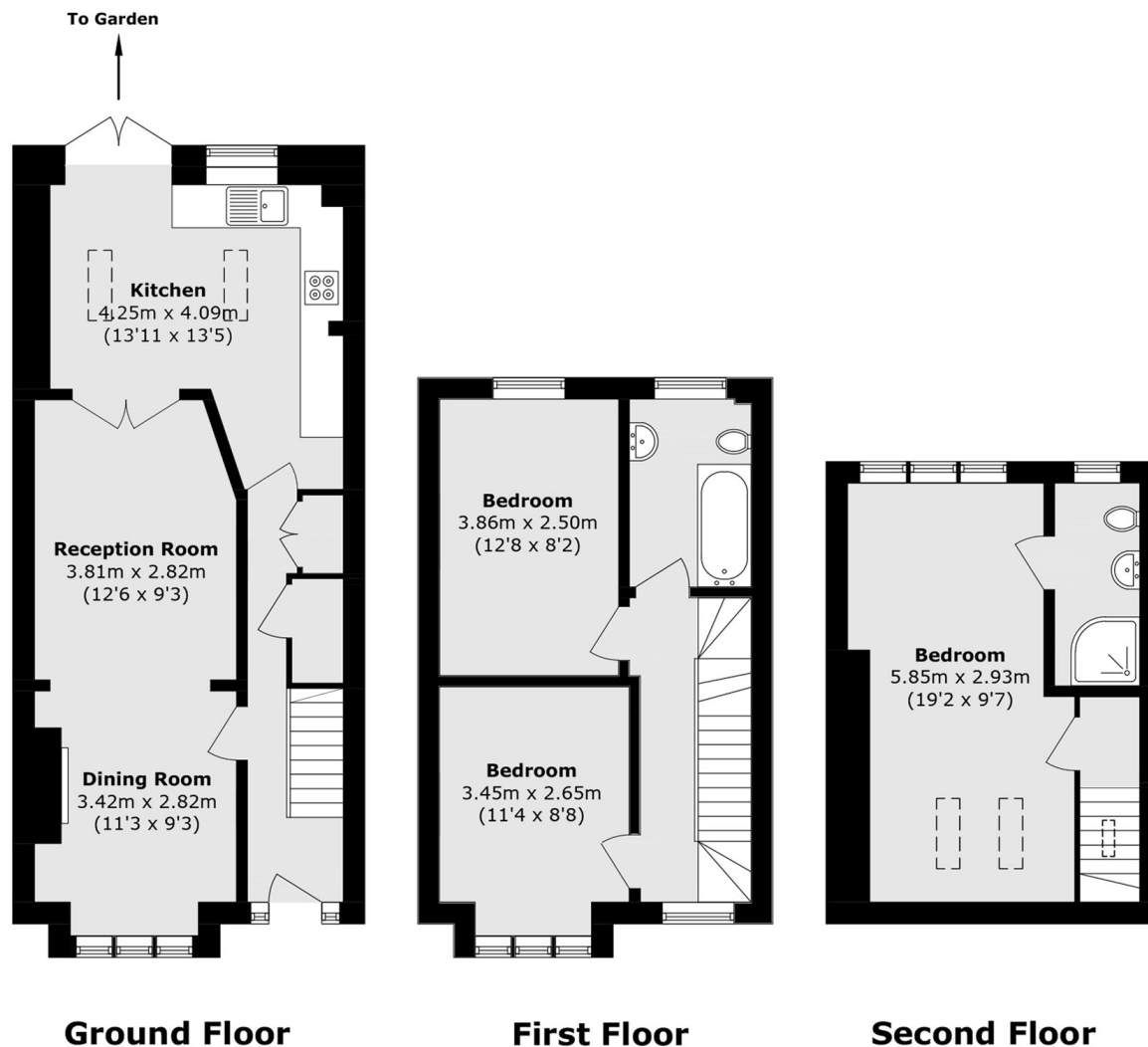

Ground Floor

First Floor

Second Floor

Total Area (approx.): 100.2 sq. m (1078.5 sq. ft)