



*Jordan fishwick*

Chapel Milton Chapel-En-Le-Frith High Peak

# Chapel Milton Chapel-En-Le-Frith High Peak SK23 0QQ

£269,950



## The Property

\*\*\* Immaculately presented and a real show stopper \*\*\* Beautifully updated and refurbished in recent years, this spacious, stone built mid-terraced cottage home has to be seen. Versatile accommodation arranged over three floors, private gardens and OFF ROAD PARKING. Wealth of features and architecturally interesting views of the historic viaduct in Chapel Milton. Comprising: living room with wood burning stove, re-fitted dining kitchen, utility/cloaks area, wc, first floor master bedroom, bathroom with white suite and second bedroom with superb spiral staircase leading to a useful loft room with Velux skylight windows. Perfect for many types of buyer. Viewing highly recommended.



- Stunning Character Property
- Arranged Over Three Floors
- Two Double Bedrooms Plus Loft Room
- Beautifully Presented Throughout
- Frontage, Rear Garden with Store and OFF ROAD PARKING
- Wood Burning Stove and Features
- Viaduct Views
- Part of a Small Hamlet Bur Convenient For Amenities
- Perfect First Time Buy

**Postcode** SK23 0QQ

**EPC Rating**

**Local Authority** High Peak

**Council Tax**

B

Energy Efficiency Rating		Current	Potential
Very energy efficient - lower running costs			
(92 plus)	A		
(81-91)	B		
(69-80)	C		
(55-68)	D		
(39-54)	E		
(21-38)	F		
(1-20)	G		
Not energy efficient - higher running costs			
<b>England &amp; Wales</b>		EU Directive 2002/91/EC 	



GROUND FLOOR

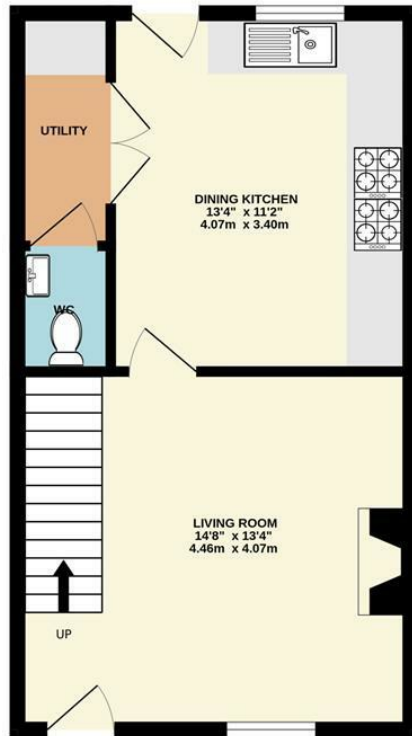

1ST FLOOR

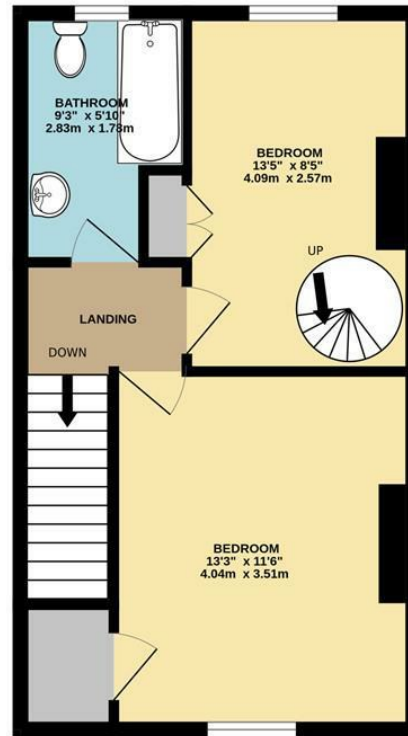

2ND FLOOR

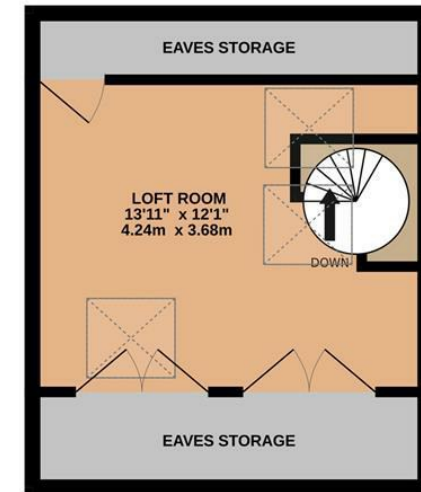

Whilst every attempt has been made to ensure the accuracy of the floorplan contained here, measurements of doors, windows, rooms and any other items are approximate and no responsibility is taken for any error, omission or mis-statement. This plan is for illustrative purposes only and should be used as such by any prospective purchaser. The services, systems and appliances shown have not been tested and no guarantee as to their operability or efficiency can be given.  
Made with Metropix ©2026



These particulars are believed to be accurate but they are not guaranteed and do not form a contract. Neither Jordan Fishwick nor the vendor or lessor accept any responsibility in respect of these particulars, which are not intended to be statements or representations of fact and any intending purchaser or lessee must satisfy himself by inspection or otherwise as to the correctness of each of the statements contained in these particulars. Any floorplans on this brochure are for illustrative purposes only and are not necessarily to scale.

Offices at: Chorlton, Didsbury, Disley, Hale, Glossop, Macclesfield, Manchester Deansgate, Manchester Whitworth Street, New Mills, Sale, Wilmslow and Withington

14 Market St, Disley, Cheshire, Stockport SK12 2AA

01663 767878

disley@jordanfishwick.co.uk

www.jordanfishwick.co.uk