



Thurloe Place
South Kensington, SW7

CHESTERTONS





A fantastic three bedroom lateral apartment situated on the second floor (with lift) situated between South Kensington and Knightsbridge, moments away from Harrods.

- Three bedroom lateral apartment located in South Kensington
- Three bedrooms, three bathrooms (two en-suites), eat-in kitchen, utility room, reception room
- Benefiting from wooden floors all throughout, high ceilings, 24/7 porter, lift
- Greatly located in between South Kensington and Knightsbridge, close to both tube stations

£5,800 pcm

Additional tenant charges apply (fees apply to non-AST tenancies only)

Tenancy Agreement Fee: £300

References per Tenant/Guarantor: £60

Inventory check (approx. £100 – £250 inc. VAT)

chestertons.co.uk/property-to-rent/applicable-fees

Energy Efficiency Rating		Current	Potential
95-100	A		
81-94	B		
69-80	C		
55-68	D	63	72
39-54	E		
21-38	F		
1-20	G		

Not energy efficient - higher running costs

EU Directive 2002/91/EC
England, Scotland & Wales

Minimum Term: 12 months
Deposit Required: £8,030.77
Local Authority: Kensington and Chelsea
Council Tax Band: G
EPC Rating: D
Furnished

Chestertons South Kensington Lettings

44-48 Old Brompton Road
 South Kensington
 London
 SW7 3DY

southkensingtonlettingsusers@chestertons.co.uk
 02075891244



Empire House, SW7

Approximate gross internal area

1221 sq ft / 113.43 sq m

Key :
CH - Ceiling Height

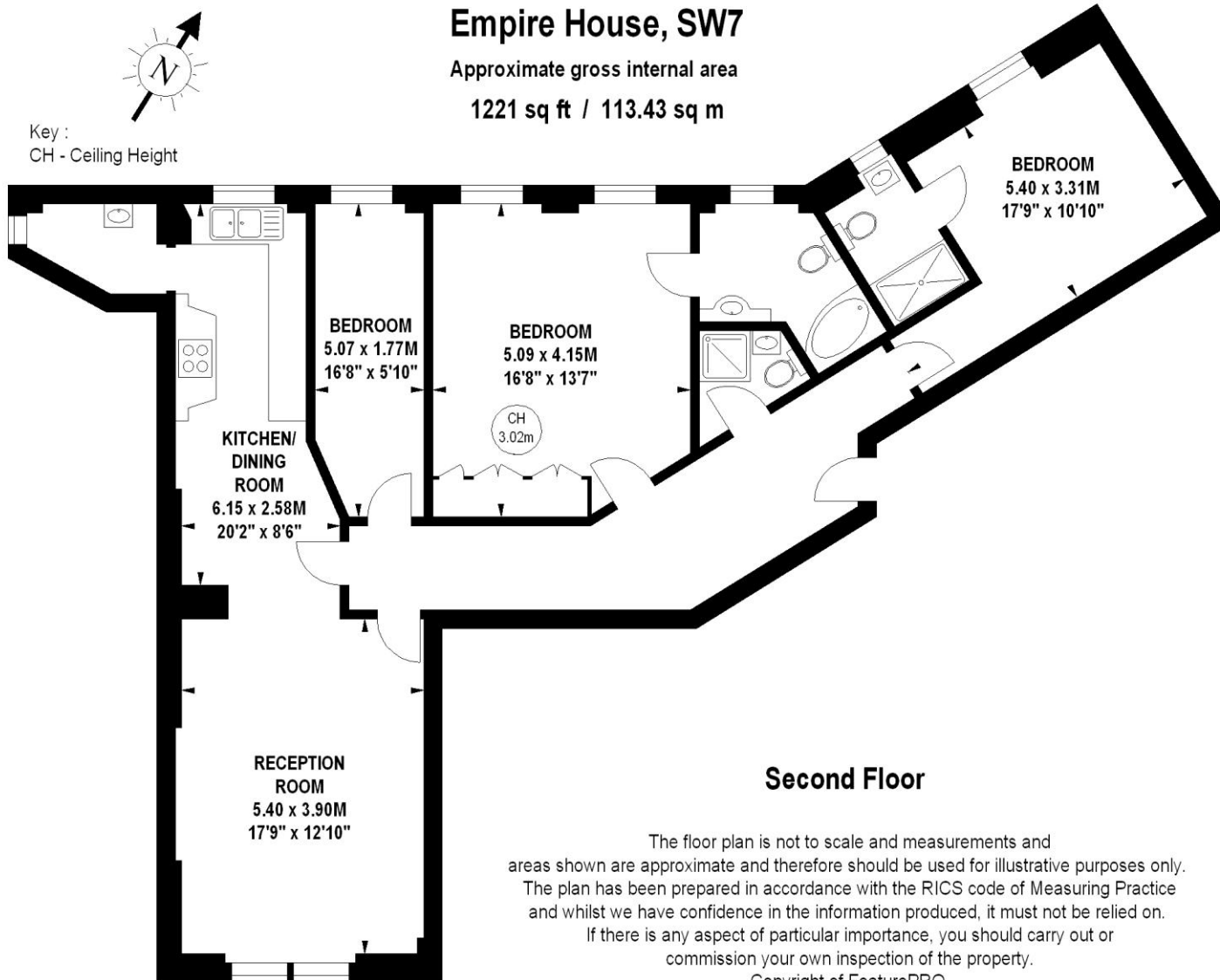

Second Floor

The floor plan is not to scale and measurements and areas shown are approximate and therefore should be used for illustrative purposes only.

The plan has been prepared in accordance with the RICS code of Measuring Practice and whilst we have confidence in the information produced, it must not be relied on.

If there is any aspect of particular importance, you should carry out or commission your own inspection of the property.

Copyright of FeaturePRO.

