



1 THE ROUNDWAY

LONDON, N17 7EQ

£290,000
LEASEHOLD

Located on the fourth floor of a well-maintained modern development, this spacious one-bedroom apartment offers over 540 sq. ft. of bright and well-balanced accommodation, complete with secure allocated parking. Perfectly suited to first-time buyers, professionals or investors, the property enjoys generous room proportions throughout and is ideally positioned for excellent transport connections into Central London.

The accommodation comprises a superb reception room measuring over 16 ft in length, providing ample space for both living and dining, while the separate fitted kitchen offers an abundance of storage and worktop space for those who enjoy cooking and a Juliet balcony, with stunning views out towards Alexandra Palace. The double bedroom is generously proportioned and benefits from plenty of natural light, complemented by a well-appointed three-piece bathroom suite and a welcoming entrance hall with additional storage. The apartment has been thoughtfully designed to maximise space and functionality, creating a

DouglasPryce

The Roundway, N17 7EQ

Approx Gross Internal Area = 50.2 sq m / 540 sq ft

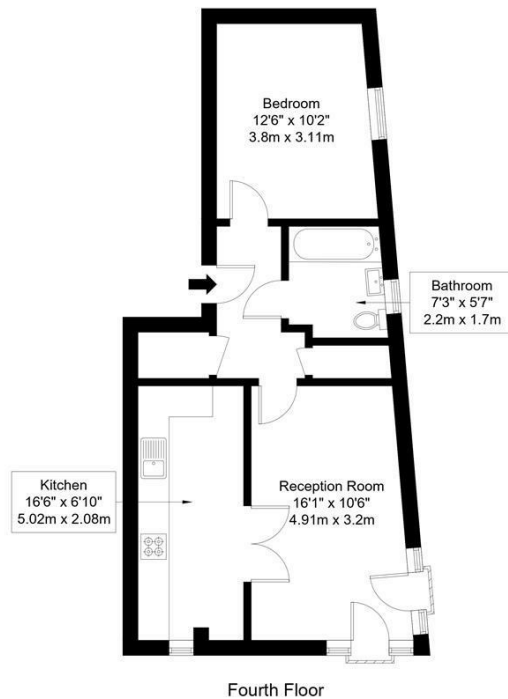

Ref :

Copyright **BLEU PLAN**

The Floor plan is not to scale and measurements and areas shown are approximate and therefore should be used for illustrative purposes only. The plan has been prepared in accordance with the RICS code of Measuring Practice and whilst we have confidence in the information produced it must not be relied on. Maximum lengths and widths are represented on the floor plan. If there is any aspect of particular importance, you should carry out or commission your own inspection of the property.
Copyright © BleuPlan

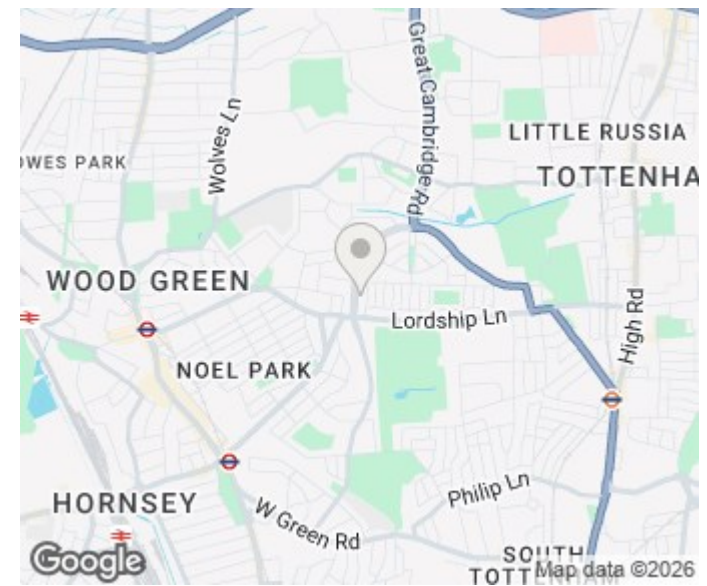

Energy Efficiency Rating		Current	Potential
Very energy efficient - lower running costs			
(92 plus) A			
(81-91) B			
(69-80) C		80	81
(55-68) D			
(39-54) E			
(21-38) F			
(1-20) G			
Not energy efficient - higher running costs			
England & Wales		EU Directive 2002/91/EC	

Agents Note: Whilst every care has been taken to prepare these particulars, they are for guidance purposes only. All measurements are approximate and are for general guidance purposes only and whilst every care has been taken to ensure their accuracy, they should not be relied upon and potential buyers/tenants are advised to recheck the measurements

Sales
Verdant Lane
London
SE6 1LF

07887933642
glenn@douglaspryce.co.uk
www.douglaspryce.co.uk

DouglasPryce