

HUNTERS[®]

HERE TO GET *you* THERE



Manor Close

Bracknell, RG42 2BA

Asking Price £550,000



EXTENSION POTENTIAL STPP

Located in the popular area of Priestwood is this spacious three bedroom detached home benefitting from garage, driveway parking and a large private rear garden.

The property comprises a 17'9 lounge diner, separate kitchen leading to a garden room with french doors onto your garden.

To the first floor you have a 14'9 master bedroom with built in wardrobes, a 10'1 second bedroom, separate bathroom and a good size third bedroom.

Manor Close is perfectly situated close to Jocks Lane Park, well regarded schools and easy access to Bracknell town centre and the well-known Lexicon shopping centre.



Area Map



Floor Plans

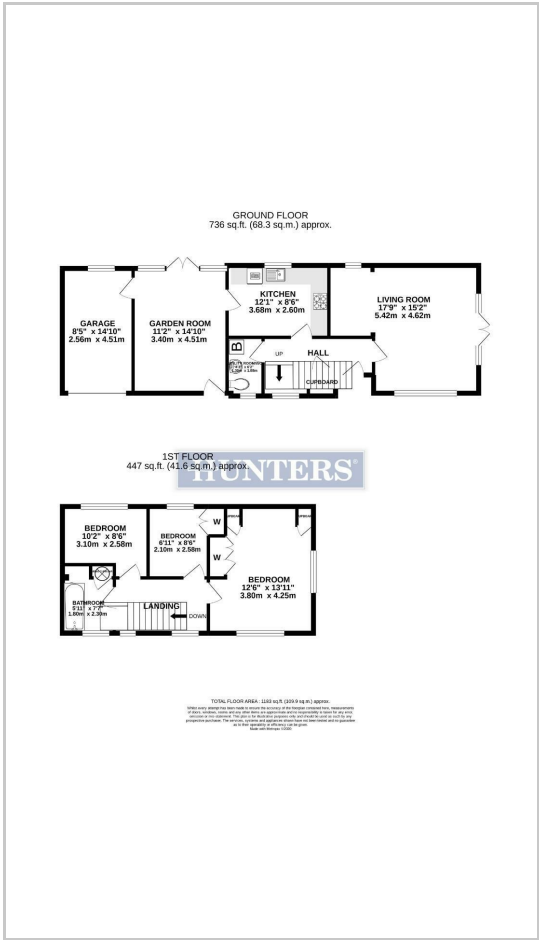

Energy Efficiency Graph

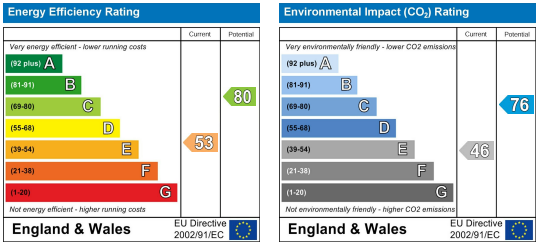

These particulars are intended to give a fair and reliable description of the property but no responsibility for any inaccuracy or error can be accepted and do not constitute an offer or contract. We have not tested any services or appliances (including central heating if fitted) referred to in these particulars and the purchasers are advised to satisfy themselves as to the working order and condition. If a property is unoccupied at any time there may be reconnection charges for any switched off/disconnected or drained services or appliances - All measurements are approximate.

THINKING OF SELLING? If you are thinking of selling your home or just curious to discover the value of your property, Hunters would be pleased to provide free, no obligation sales and marketing advice. Even if your home is outside the area covered by our local offices we can arrange a Market Appraisal through our national network of Hunters estate agents.