



## Sloane Avenue, SW3

£595,000

A spacious one bedroom apartment that has been finished to a high standard. This property would work excellently as a rental investment or London base.

Nell Gwynn House is a popular, portered block located on Sloane Avenue which is in close proximity to Sloane Square, South Kensington and the King's Road.

### Features

- 24 Hour Porter
- Recently Refurbished
- One Bedroom
- Lift
- One Bathroom
- Ideal Rental Investment

# Sloane Avenue, London, SW3

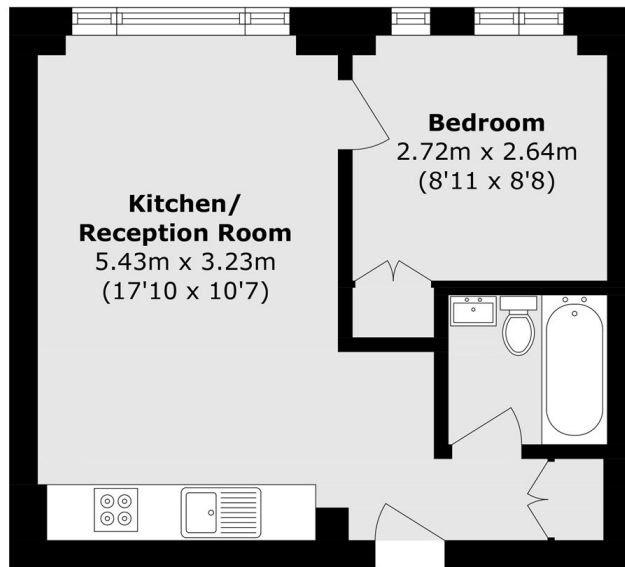

## Fourth Floor

Total area (approx.): 33.2 sq. m (357.4 sq. ft)