



**£280,000**

Foxwalks Avenue, Bromsgrove B61 7NE

**GUEST**  
ESTATE AGENTS



Three bedroom end terrace home  
Generous corner plot  
Garage conversion completed in 2024  
Living room & dining room  
Conservatory & garden room  
Kitchen with breakfast bar  
Downstairs WC & utility area  
Front windows replaced in 2024  
Combi boiler  
Large rear garden

Occupying a generous corner plot on Foxwalks Avenue, this well proportioned three bedroom end terrace home immediately stands out for the exceptional amount of outside space on offer something increasingly difficult to find. Set back behind a substantial front garden with mature planting and a neatly maintained lawn, the property enjoys both privacy and kerb appeal, while the larger-than-average rear garden and recent garage conversion make this a home that offers far more than first meets the eye.

Positioned behind a low brick wall, the attractive frontage creates a welcoming first impression, with established shrubs, mature planting and a generous lawn giving the home a lovely sense of privacy and space. To the side, there is off-road parking for one vehicle along with a gate providing convenient access to the rear garden.

You enter the property via an enclosed porch into the central hallway. To the right is the living room, positioned to the front aspect with a substantial window allowing excellent natural light to fill the space. There is a designated area for an electric fire, creating a natural focal point, while patio doors at the rear lead directly into the conservatory, providing a seamless extension of the living accommodation and lovely views over the garden.

To the left of the hallway is the separate dining room, with a large front facing window and useful understairs storage. A wide archway leads through into the kitchen, creating an open yet defined layout ideal for both everyday family life and entertaining. The kitchen overlooks the rear garden and features fitted cabinetry, a breakfast bar and integrated appliances including an oven, gas hob, extractor and fridge/freezer, offering both practicality and good storage.

A particularly valuable addition is the garage conversion, completed in 2024, which creates an additional reception room offering fantastic flexibility. Whether used as a family room, home office, playroom or guest space, it significantly enhances the versatility of the property. This area



Three bedroom end terrace home  
Generous corner plot  
Garage conversion completed in 2024  
Living room & dining room  
Conservatory & garden room  
Kitchen with breakfast bar  
Downstairs WC & utility area  
Front windows replaced in 2024  
Combi boiler  
Large rear garden

Occupying a generous corner plot on Foxwalks Avenue, this well proportioned three bedroom end terrace home immediately stands out for the exceptional amount of outside space on offer something increasingly difficult to find. Set back behind a substantial front garden with mature planting and a neatly maintained lawn, the property enjoys both privacy and kerb appeal, while the larger-than-average rear garden and recent garage conversion make this a home that offers far more than first meets the eye.

Positioned behind a low brick wall, the attractive frontage creates a welcoming first impression, with established shrubs, mature planting and a generous lawn giving the home a lovely sense of privacy and space. To the side, there is off-road parking for one vehicle along with a gate providing convenient access to the rear garden.

You enter the property via an enclosed porch into the central hallway. To the right is the living room, positioned to the front aspect with a substantial window allowing excellent natural light to fill the space. There is a designated area for an electric fire, creating a natural focal point, while patio doors at the rear lead directly into the conservatory, providing a seamless extension of the living accommodation and lovely views over the garden.

To the left of the hallway is the separate dining room, with a large front facing window and useful understairs storage. A wide archway leads through into the kitchen, creating an open yet defined layout ideal for both everyday family life and entertaining. The kitchen overlooks the rear garden and features fitted cabinetry, a breakfast bar and integrated appliances including an oven, gas hob, extractor and fridge/freezer, offering both practicality and good storage.

A particularly valuable addition is the garage conversion, completed in 2024, which creates an additional reception room offering fantastic flexibility. Whether used as a family room, home office, playroom or guest space, it significantly enhances the versatility of the property. This area



# Floorplan

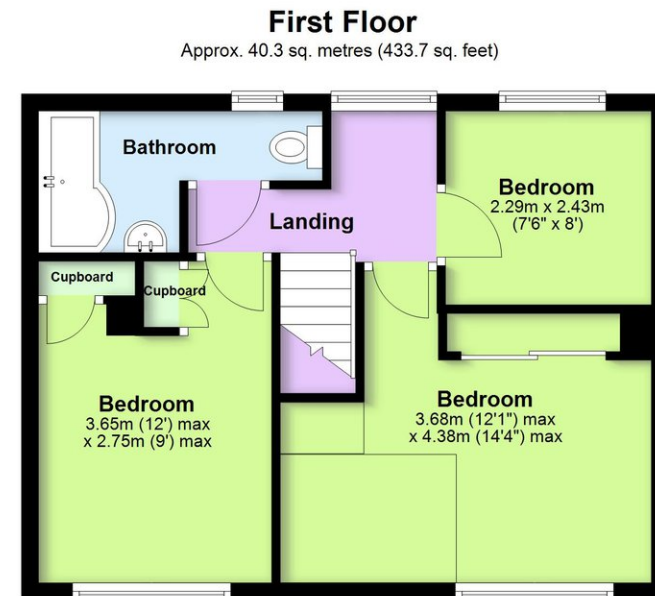

Total area: approx. 114.0 sq. metres (1227.2 sq. feet)

Overall area includes the garden room, which is not shown in its actual position. Whilst every attempt has been made to ensure the accuracy of this floorplan, measurements of doors, windows, rooms and any other item are approximate, and no responsibility is taken for any error, omission, or mis-statement. This plan is for illustrative purposes only and should be used as such by any prospective purchaser.

Plan produced using PlanUp.

### **Want to view this property?**

Call us on 01527 306420, or email [hello@guestestateagents.com](mailto:hello@guestestateagents.com)

### **Property to sell?**

Guest Estate Agents can offer you an outstanding level of service, successfully selling property in and around Bromsgrove. For a free valuation, call us on 01527 306420, or email [hello@guestestateagents.com](mailto:hello@guestestateagents.com)

### **Independent mortgage advice**

We recommend Guest Independent Mortgage Advice. Call 01527 306425, or email [hello@guestindependent.com](mailto:hello@guestindependent.com) to arrange an initial chat with no pressure or obligation.

### **Solicitor / Conveyancer**

Getting the right firm to do the legal work can make or break a sale. Just ask us for a recommendation / quote,

### **Lettings**

For fully managed lets or just a tenant find, we recommend Douglas Lettings. More info at [www.douglaslettings.co.uk](http://www.douglaslettings.co.uk)

### **Everything else**

For surveys, removals, EPCs, or any other property related needs, we can recommend someone reliable to help you.

### **Our contact details**

Phone: 01527 306420

Email: [hello@guestestateagents.com](mailto:hello@guestestateagents.com)

Address: 1 St Godwald's Road, Aston Fields, Bromsgrove B60 3BN

### **Disclaimer**

You should not rely on statements made by Guest Estate Agents in these details, or by word of mouth, or in writing, as being factually accurate about the property, its condition, or its value. The tenure needs to be verified via your solicitors. Areas, measurements and distances are approximate. Any reference to alterations or extensions, or use of, or any part of the property does not mean that the necessary planning, building regulations or any other consent has been obtained. A buyer must find out by inspection or other ways to verify that these matters have been dealt with and that the information is correct.

