



18 Jubilee Close

Somerset, TA18 8FD

£850 PCM

MAYFAIR
TOWN & COUNTRY

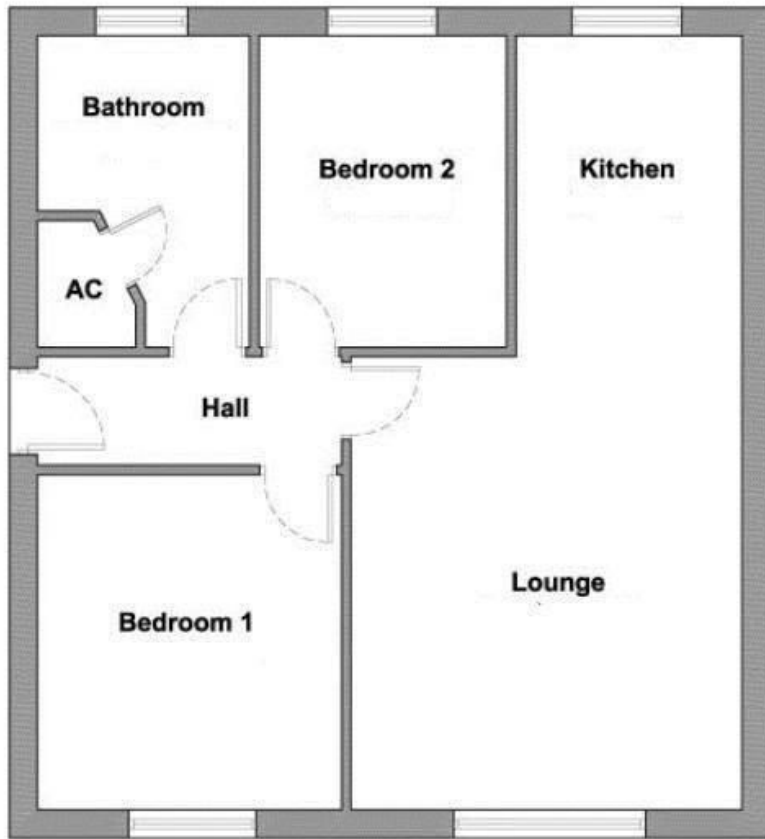

PROPERTY DESCRIPTION

This well presented two bedroom ground floor flat is located on the outskirts of Crewkerne in a modern development. The property benefits from electric heating throughout and double glazing. Accommodation briefly comprises; Entrance hall, open plan kitchen/sitting room ,two double bedrooms and bathroom, Allocated parking.

- Modern Ground Floor Apartment
- Beautifully Presented
- Two Double Bedrooms
- Allocated Parking
- Close To Crewkerne
- Fully Fitted Kitchen
- Council Tax B
- EPC Rating : C

Deposit: £980

Furnishing: Unfurnished

Local Authority

South Somerset District Council Council Tax Band: B

Tenure:

EPC Rating: C

Energy Efficiency Rating	
Current	Potential
Vary energy efficient - lower running costs	
A (92 plus)	
B (81-91)	
C (69-80)	
D (55-68)	
E (39-54)	
F (21-38)	
G (1-20)	
Not energy efficient - higher running costs	
70	71
EU Directive 2002/91/EC	
England & Wales	



TO ARRANGE A VIEWING OR FOR FURTHER INFORMATION ON THIS PROPERTY PLEASE CONTACT OUR SALES TEAM

01460 74200

crewkerne@mayfairproperties.net



We would like to inform prospective purchasers that these sales particulars have been prepared as a general guide only. If there are any important matters likely to affect your decision to buy, please contact us before viewing the property.

1. Survey - A detailed survey has not been carried out, nor the services, appliances and fittings tested.
2. Floorplans All measurements walls, doors, windows, fittings and appliances, their sizes and locations are shown conventionally and are approximate and cannot be regarded as being representative either by the seller or his agent. Room sizes should not be relied upon for furnishing purposes and are approximate.
3. Mayfair Town & Country may make the following referrals and in exchange receive an introduction fee: Star Legal up to £120 inc VAT, Simply Conveyancing up to £240 inc VAT, HD Financial Ltd - introduction fee of up to £240 inc VAT

