



Parklands, KT5

£285,000

This one bedroom first floor apartment is set in an imposing detached Victorian house on a quiet road. The property has high ceilings, a spacious living/kitchen/diner, double bedroom, large communal gardens and a long lease.

Parklands is a peaceful sought after road just half a mile from Surbiton Station and high street with its fast trains into London, and its selection of shops, cafes, bars and restaurants.

Features

- One Bedroom
- Period Conversion
- Imposing Victorian Villa
- Share of Freehold
- Communal Gardens
- Tree Lined Road

Parklands, Surbiton, KT5

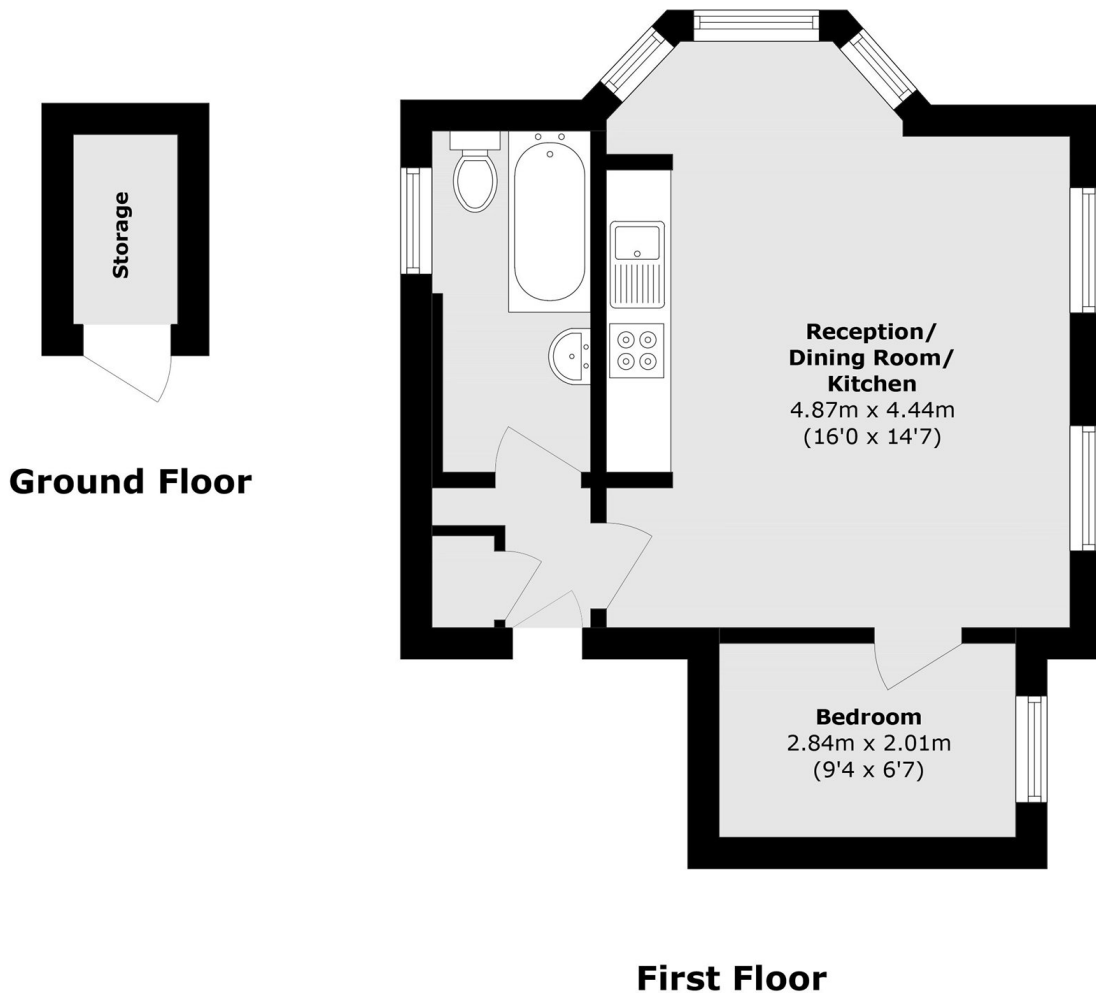

Total area (approx.): 36.6 sq. m (393.9 sq. ft)
External Storage area (approx.): 1.8 sq. m (19.3 sq. ft)