



Orchard End Sandfield Lane, Sedgeberrow

Offers in Region of **£700,000**





Orchard End Sandfield Lane

Sedgeberrow, Evesham

Council Tax band: F

Tenure: Freehold

EPC Energy Efficiency Rating:

EPC Environmental Impact Rating:

- Substantial detached bungalow extending to approx. 1,899 sq. ft
- Generous and private plot with beautifully landscaped gardens
- Three well-proportioned bedrooms
- Open-plan kitchen/breakfast/ family room with central island
- Well-appointed family bathroom
- Detached garage and extensive driveway parking
- Light and versatile single-storey accommodation
- Sought-after village location with countryside surroundings
- Separate dining room with garden views and access
- Expansive and bright hallway







Ground Floor

Approx. 176.5 sq. metres (1899.9 sq. feet)

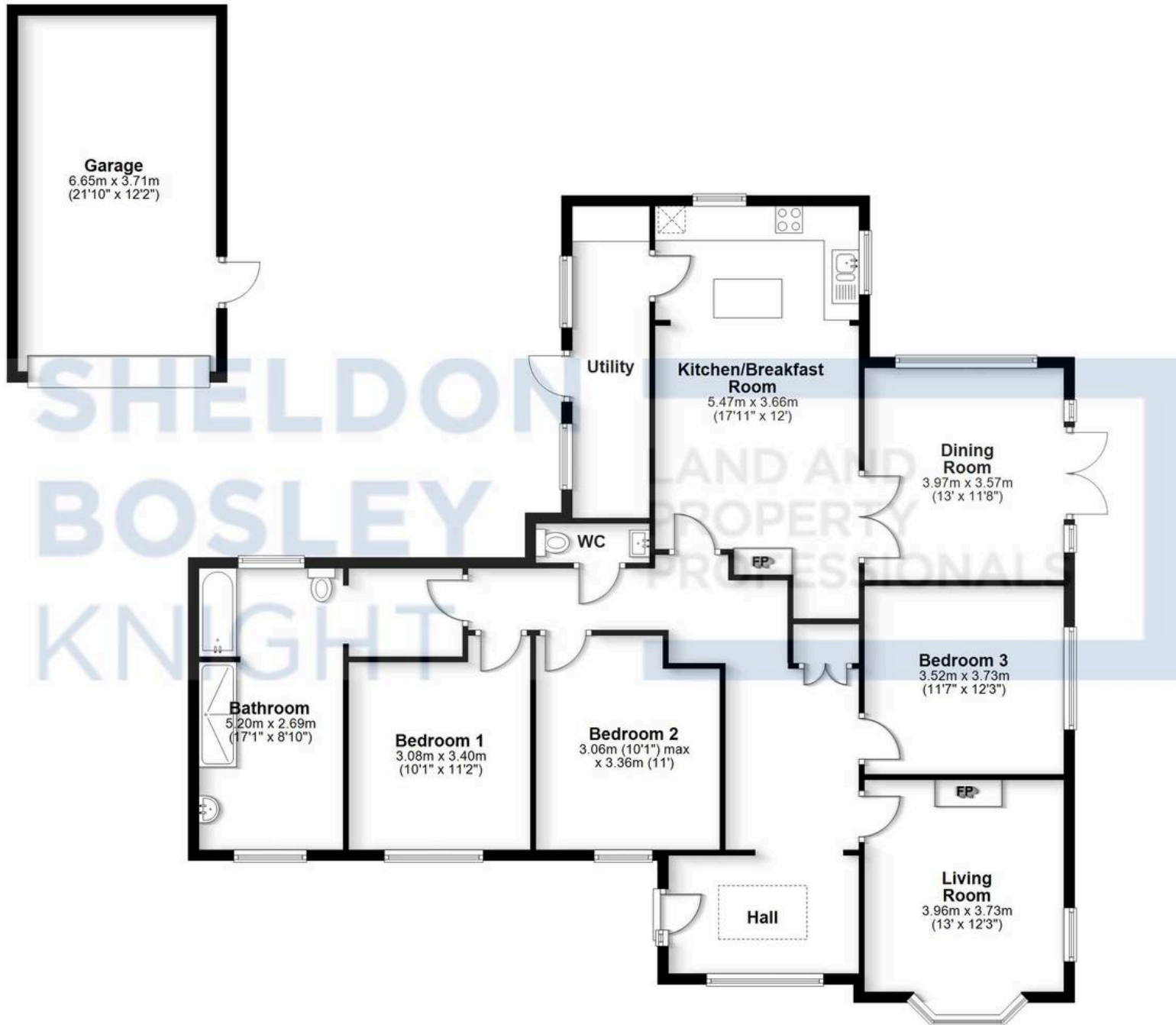

Total area: approx. 176.5 sq. metres (1899.9 sq. feet)

All efforts have been made to ensure the measurements are accurate on this floor plan, however these are for guidance purposes only.
Plan produced using PlanUp.



Sheldon Bosley Knight Evesham & Pershore

Sheldon Bosley Knight, 1 Bridge Street, Evesham - WR11 4SQ

01386444900 · eveshamsales@sheldonbosleyknight.co.uk · www.sheldonbosleyknight.co.uk/

DISCLAIMER

All fixtures and fittings mentioned in these particulars are included in the sale, all others in the property are specifically excluded.

Photographs are reproduced for general information and it must not be inferred that any item is included for sale with the property.

These particulars are thought to be materially correct. Their accuracy is not guaranteed and they do not form part of any contract.