



GROUP 4

31 Draycott Avenue | | LONDON | SW3 3BS

£1,990 Per month

ESON2
REAL ESTATE

Key features

- Bright, design-led open-plan layout
- Sleek integrated kitchen
- Large windows with excellent natural light
- Contemporary high-spec shower room
- 24-hour residents' gym
- Stylish co-working space
- Secure entry with CCTV

Description

A newly refurbished studio apartment in Chelsea SW3, offering modern open-plan living with a fully fitted kitchen, stylish shower room, and excellent natural light. Residents benefit from 24-hour gym access, co-working space, secure entry, and CCTV. Ideally located close to Sloane Square, South Kensington, shops, cafés, and transport links.

Directions



A beautifully refurbished, design-led studio set within an elegant period building in the heart of Chelsea, a stroll away from sought after Salone square SW3.



Floor plans

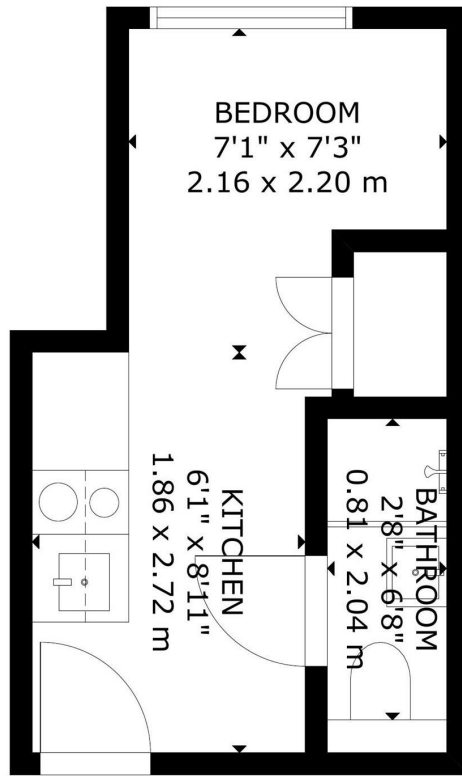

GROSS INTERNAL AREA
 TOTAL: 12 m²/134 sq.ft
 FIRST FLOOR: 12 m²/134 sq.ft
 SIZE AND DIMENSIONS ARE APPROXIMATE, ACTUAL MAY VARY

FIRST FLOOR

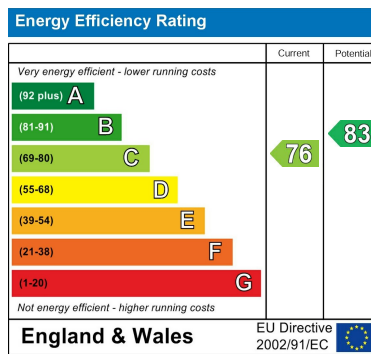

Council Tax Band New Build EPC Rating C



301 Michelin House 81 Fulham road
 London
 Greater London
 SW3 6RD
 07920 257649
 fayeel@eson2.co.uk
 www.eson2.co.uk