



## Woodhill Crescent

Harrow

£875,000

Davidson Frost-Wellings are pleased to present this four bedroom, two bathroom semi detached house on Woodhill crescent.

Located in a sought-after area, this charming period semi-detached house boasts 4-5 bedrooms and a wealth of character throughout. The property features a spacious garden, perfect for relaxing or entertaining, as well as a delightful patio area ideal for al fresco dining and a large storage room under the raised patio. With off-street parking available to the front and a side pedestrian access, convenience is key for residents.

Internally, the house offers a bright and airy living space, with a well-appointed kitchen and stylish bathrooms adding to the appeal. The bedrooms are generously sized, providing ample room for a growing family or for guests.

Situated within easy reach of local amenities, schools, and transport links, this property offers the perfect blend of comfort and convenience.

Brent council tax band F

### Viewing

Please contact our Davidson Frost-Wellings Office on 020 8954 8806 if you wish to arrange a viewing appointment for this property or require further information.



Floor Plan

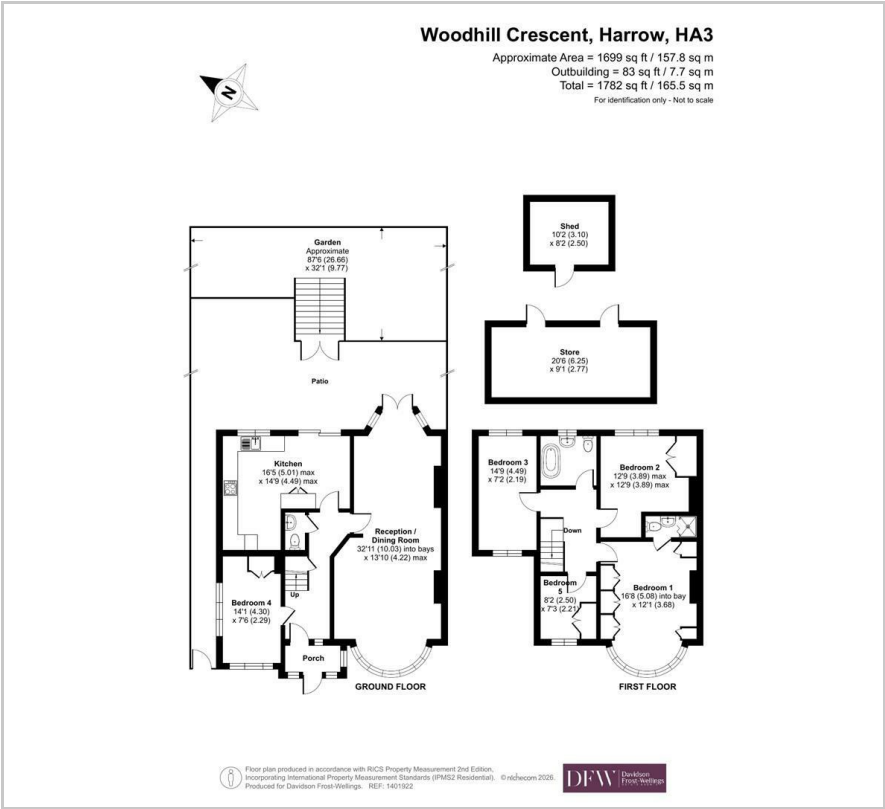

Area Map

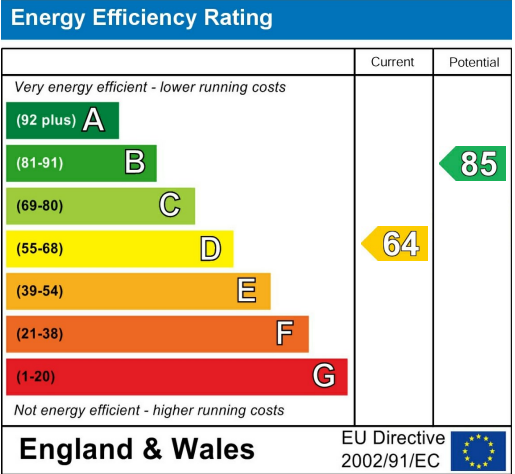
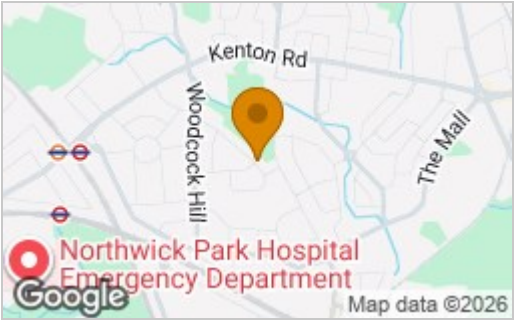

These particulars, whilst believed to be accurate are set out as a general outline only for guidance and do not constitute any part of an offer or contract. Intending purchasers should not rely on them as statements of representation of fact, but must satisfy themselves by inspection or otherwise as to their accuracy. No person in this firms employment has the authority to make or give any representation or warranty in respect of the property.