

ARDEN & WAY

BLOCK MANAGEMENT & LETTINGS



Anchor Court 80 Southwood Road

, Hayling Island, PO11 9UR

£280,000

Arden & Way are pleased to present this two bedroom apartment occupying a prime penthouse position, this beautifully arranged apartment enjoys uninterrupted sea views and a well-balanced layout ideal for both everyday living and entertaining.

Upon entering, you are welcomed by a spacious reception hall that provides access to all principal rooms. The heart of the home is the impressive living/dining room, a generous dual-purpose space with direct access to a private balcony—perfect for taking in the panoramic coastal outlook. Adjacent, the separate kitchen is thoughtfully laid out with ample workspace and storage.

The property offers two well-proportioned double bedrooms. The master bedroom benefits from its own private balcony and a contemporary en-suite shower room, creating a peaceful retreat with stunning views. The second bedroom is equally comfortable and is served by a family bathroom.

Additional features include a garage providing valuable extra storage or parking.

With its elevated position, dual balconies, and uninterrupted sea views, this penthouse apartment presents a rare opportunity to enjoy coastal living in a bright and spacious home.

For more information or to arrange a viewing please contact Arden & Way.

Viewing

Please contact our Arden & Way Office on 02392 460 899 if you wish to arrange a viewing appointment for this property or require further information.



2



2



1



Floor Plan

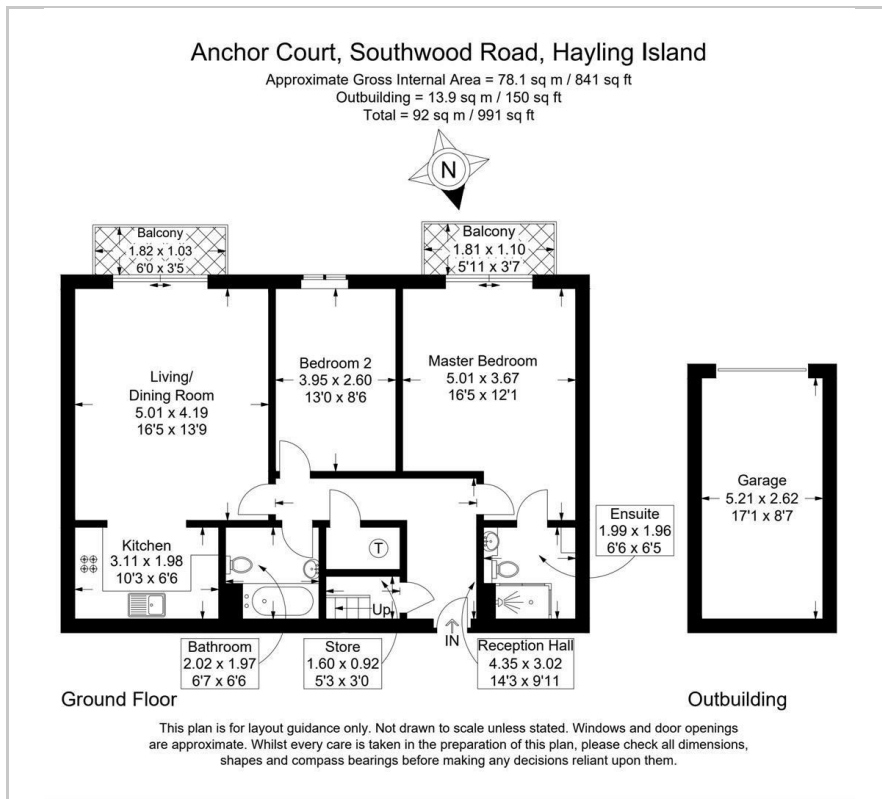

Area Map

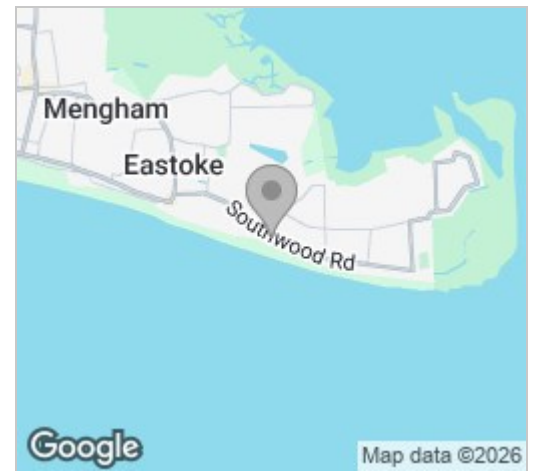

Energy Efficiency Graph



These particulars, whilst believed to be accurate are set out as a general outline only for guidance and do not constitute any part of an offer or contract. Intending purchasers should not rely on them as statements of representation of fact, but must satisfy themselves by inspection or otherwise as to their accuracy. No person in this firm's employment has the authority to make or give any representation or warranty in respect of the property.