 **2**
Bedrooms

 **1**
Bathroom



Charming Two-Bedroom Cottage with Re-Fitted Kitchen and Private Garden – No Onward Chain

This well-presented character cottage offers a delightful blend of period charm and modern convenience, ideal for first-time buyers or downsizers. Set across three floors, the property features a stylish re-fitted kitchen, two generous double bedrooms, and a first-floor bathroom. The home benefits from double glazing and gas central heating throughout..

The ground floor comprises a welcoming living room and a thoughtfully updated kitchen. On the first floor, you'll find a spacious double bedroom and a modern bathroom, while the second floor hosts an additional double bedroom with ample natural light. Outside, the enclosed rear garden provides a low-maintenance space for relaxing or entertaining.

Located within easy reach of local amenities and transport links, this charming cottage combines comfort, character, and convenience.

Crewkerne is a picturesque market town nestled between Yeovil and Taunton, offering a superb blend of local amenities and countryside charm. The town features a Waitrose superstore, chemists, banks, a doctor's surgery, and a range of leisure and recreational facilities including a public swimming pool, pubs, restaurants, schools, and churches. Well-connected by a local bus service and a mainline railway station with direct links between London Waterloo and Exeter, Crewkerne provides excellent transport options. Yeovil lies just 9 miles away, Taunton and the M5 motorway are within 19 miles, and the stunning Dorset Coast is only 14 miles, making the town both practical and appealing for commuters and those seeking a relaxed, well-serviced lifestyle.

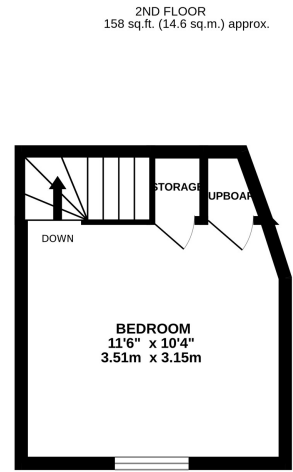
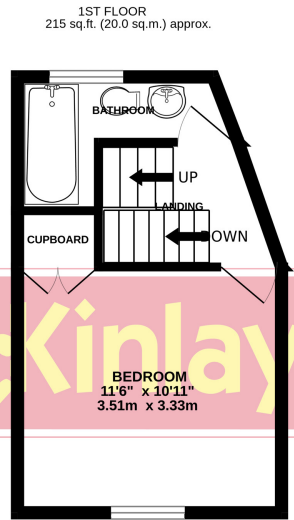
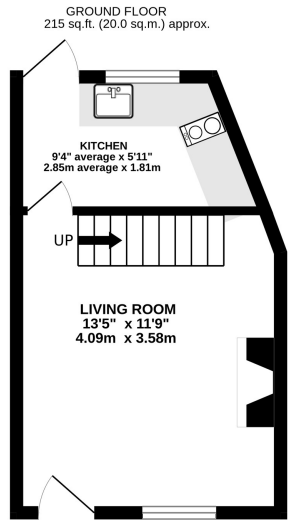

TOTAL FLOOR AREA : 588 sq.ft. (54.6 sq.m.) approx.

Whilst every attempt has been made to ensure the accuracy of the floorplan contained here, measurements of doors, windows, rooms and any other items are approximate and no responsibility is taken for any error, omission or mis-statement. This plan is for illustrative purposes only and should be used as such by any prospective purchaser. The services, systems and appliances shown have not been tested and no guarantee as to their operability or efficiency can be given.
Made with Metropix ©2025

