



Belvedere Heights

199 Lisson Grove, NW8

Asking Price £575,000

A bright 2-bedroom, 2-bathroom apartment situated on the 4th floor (with lift) of this modern purpose-built block with underground parking, resident's gym and a day porter.

The apartment offers 705 sq. ft. of lateral accommodation and is offered in good decorative condition throughout. Belvedere Heights is located approximately half a mile from Marylebone station and the multiple transport links of the Edgware Road.



Belvedere Heights

199 Lisson Grove, NW8

- 2 Bedrooms, 2 Bathrooms
- 972 Year Leasehold
- 705 sq. ft.
- Allocated Parking Space
- Day Porter
- Gym
- Lift



Tenure: Leasehold
Service Charge: £4,726pa
Ground Rent: £500pa
Local Authority: Westminster
Council Tax Band: G

Score	Energy rating	Current	Potential
92+	A		
81-91	B		
69-80	C	74 C	77 C
55-68	D		
39-54	E		
21-38	F		
1-20	G		

Chestertons St John's Wood Sales

105 St. John's Wood Terrace
London
NW8 6PL
stjohnswood@chestertons.co.uk
020 3040 8611
chestertons.co.uk

Belvedere Heights, Lisson Grove, NW8



○ - Ceiling Height

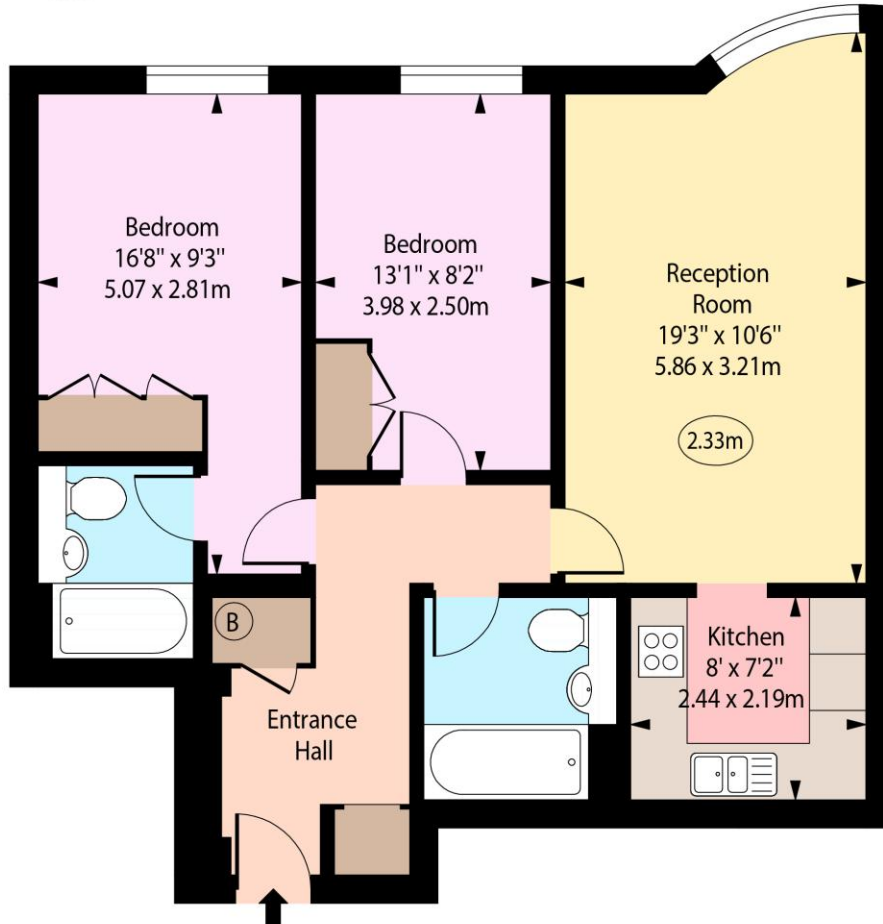

Fourth Floor

Approx Gross Internal Area 705 Sq Ft - 65.49 Sq M

Every attempt has been made to ensure the accuracy of the floor plan shown. However, all measurements, fixtures, fittings, and data shown are approximate interpretations and for illustrative purposes only. Measured according to the RICS. Not To Scale.

www.goldlens.co.uk
Produced for Chestertons
Ref. No. 031675D