



Chiswick Village, W4

£461 Per week

A two bedroom apartment located in this popular art deco development. The property is overlooking the well-maintained communal gardens and has a large bedroom and semi open plan living room.

Chiswick Village is within half a mile of both Kew Bridge and Gunnersbury stations and is also close to the M4/A4 providing excellent access in and out of town.

Features

- Two Bedrooms
- One Bathroom
- Purpose-Built Block
- First Floor
- Communal Gardens
- Semi Open Plan Kitchen

Chiswick Village, London, W4

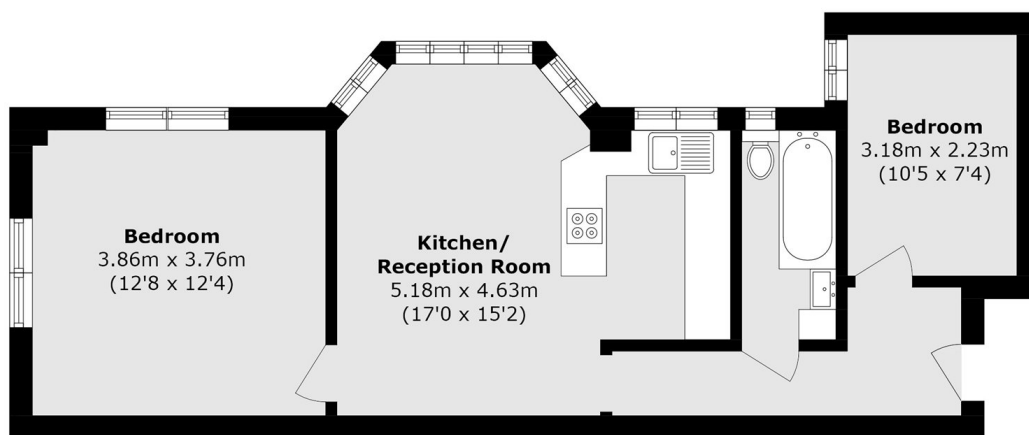

Total area (approx.): 52.4 sq. m (564.0 sq. ft)