



9 Elbow Lane, Stevenage

Stevenage

CHANDLERS

Guide Price £325,000

# 9 Elbow Lane

Stevenage, Stevenage

Council Tax band: C

Tenure: Freehold

EPC Energy Efficiency Rating: E

EPC Environmental Impact Rating: E

- Three bedroom end of terrace house
- Located in a sought after location close to local amenities
- In need of full renovation throughout
- Hallway and utility room
- Extended lounge
- Kitchen
- Three good sized bedrooms and bathroom
- Private rear garden
- Driveway to the front
- Chain Free





Approximate Gross Internal Area  
Ground Floor = 44.0 sq m / 474 sq ft  
First Floor = 36.5 sq m / 393 sq ft  
Total = 80.5 sq m / 867 sq ft

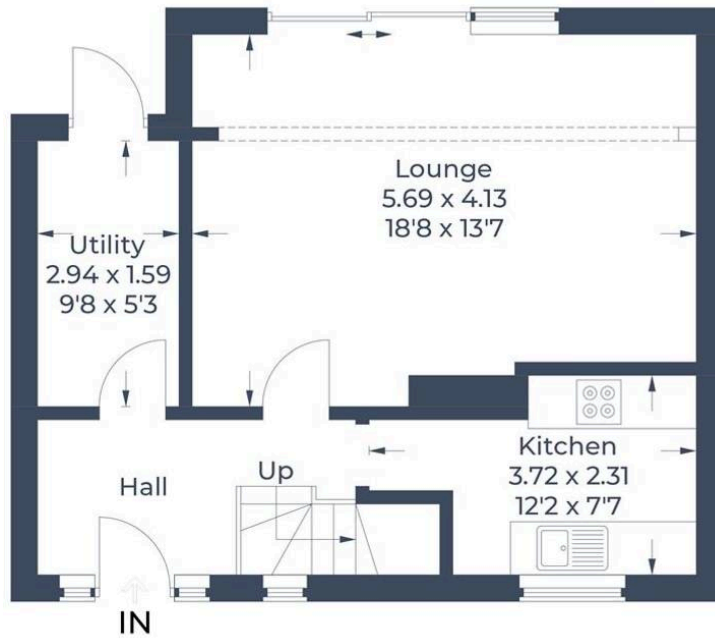

**Ground Floor**



**First Floor**

Illustration for identification purposes only,  
measurements are approximate, not to scale.  
© CJ Property Marketing

## Chandlers Estate Agents

Chandlers, 18 Market Place – SGI 1DB

01438356635

[sales@chandlers-estates.co.uk](mailto:sales@chandlers-estates.co.uk)

[www.chandlers-estates.co.uk/](http://www.chandlers-estates.co.uk/)

While we believe the details provided to be correct, we do not guarantee their accuracy. Prospective buyers should verify all information independently before making any decisions. No responsibility is taken for any errors, omissions, or misstatements.