



Guide Price
£140,000

**Share of
Freehold**

1x  1x  1x 

**Red Lion House, High
Street, Snodland, Kent,
ME6**

OVER 60?

Secure this property
for up to **59% less!**

Wards
Helping you move forwards



Main features

- Ready to move straight into with no onward chain
- Fantastic entertaining space in the open plan lounge/kitchen/diner
- Good size bedroom with handy storage cupboard
- Excellent amenities close by
- Peaceful location with great travel links including the M2 and M20

Accommodation

SECOND FLOOR

Entrance Hall

Lounge/Kitchen/Diner: 18'10 x 15'4 (5.74m x 4.68m)

Bedroom : 14'8 x 11'5 (4.47m x 3.48m)

Bathroom: 8'1 x 6'8 (2.47m x 2.03m)

OUTSIDE

Communal Garden

Second Floor

Approx. 52.2 sq. metres (562.1 sq. feet)

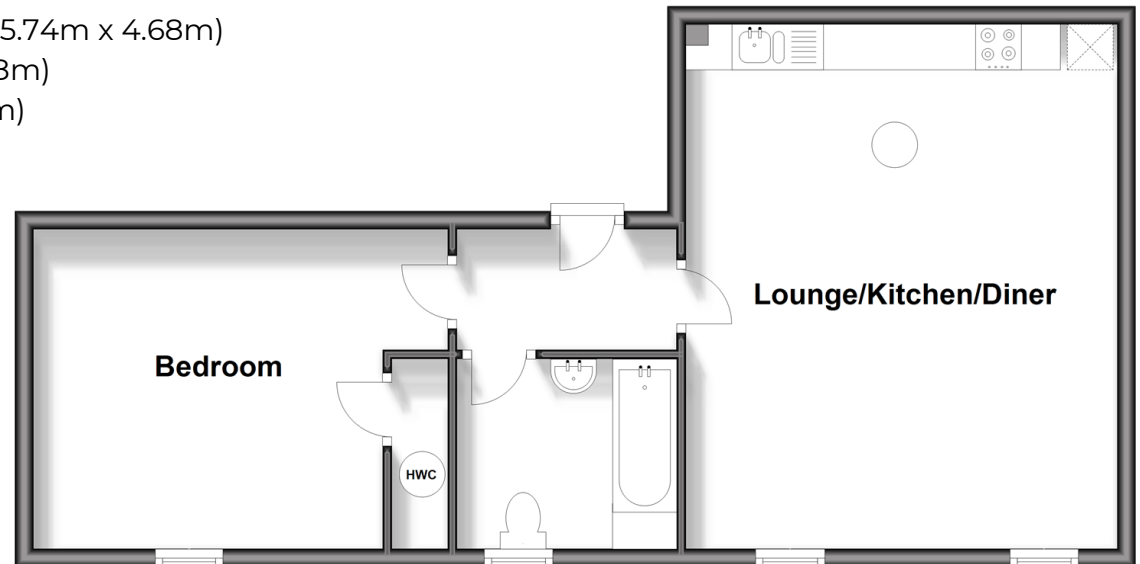

Call Snodland - 01634 245055 ■ wardsofkent.co.uk

■ Legal advice should be taken to verify fixtures/fittings, planning, alterations and/or lease details
 ■ Through a Homewise Home For Life Plan people aged 60+ can secure this property for up to 59% less, by purchasing a Lifetime Lease

■ Appliances & services are untested, dimensions are approximate and floor plans are not to scale



13821617/20260218/MM/IA