



Heatherlea Windsor Mount, Ramsey, Isle Of Man, IM8 3EA
Asking Price £419,950

- 6 Bedroom Town House
- Views of lake and mountain
 - Ideal for families
- Large family bathroom
- Overlooks Mooragh Park
- Perfect for multi-gen living
- Original and modern blended features
 - Large paved back yard
 - Viewing highly recommended



Nestled in the charming town of Ramsey on the Isle of Man, Heatherlea is a stunning townhouse that offers a unique blend of original features and modern comforts. This impressive property boasts six spacious bedrooms, making it an ideal choice for families or those seeking multi-generational living.

As you step inside, you will be greeted by a generous reception room that provide a warm and inviting atmosphere. The large family bathroom is beautifully designed, ensuring a relaxing space for all. Almost every window in the house offers breathtaking views of Mooragh Park, the serene lake, and the surrounding hilly landscape, allowing you to enjoy the natural beauty of your surroundings from the comfort of your home.

The outdoor space features large paved backyard that is perfect for summer gatherings, barbecues, or simply enjoying a quiet evening with friends and family. The location is superb, providing easy access to local amenities while maintaining a peaceful residential feel.

Heatherlea is not just a house; it is a home that promises comfort and joy for its residents. With its spacious layout and picturesque views, this property is a must-see for anyone looking to invest in a beautiful family home in Ramsey. We highly recommend scheduling a viewing to fully appreciate all that this remarkable townhouse has to offer.













Heatherlea Windsor Mount, Ramsey, Isle Of Man, IM8 3EA



BASEMENT
524 sq.ft. (48.7 sq.m.) approx.



GROUND FLOOR
549 sq.ft. (51.0 sq.m.) approx.



2ND FLOOR
514 sq.ft. (47.7 sq.m.) approx.

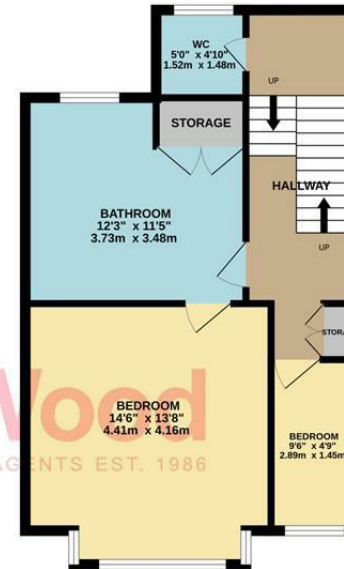

3RD FLOOR
507 sq.ft. (47.1 sq.m.) approx.



TOTAL FLOOR AREA : 2094 sq.ft. (194.5 sq.m.) approx.

Not to scale-for identification purposes only
Made with Metropix ©2026

DOUGLAS

37 VICTORIA STREET
DOUGLAS
ISLE OF MAN IM1 2LF

T 01624 620606
F 01624 677363
E info@deanwood.co.im

CASTLETOWN

COMPTON HOUSE
9 CASTLE STREET CASTLETOWN
ISLE OF MAN IM9 1LF

T 01624 825995
F 01624 825996
E castletown@deanwood.co.im

RAMSEY

LEZAYRE HOUSE
87 PARLIAMENT STREET
RAMSEY ISLE OF MAN IM8 1AQ

T 01624 816111
F 01624 816588
E ramsey@deanwood.co.im

These particulars are for information purposes only. They do not constitute or form any contract nor should any statement contained herein be relied upon as a representation of fact. Neither the vendor nor DeanWood Agencies Limited ('the firm'), nor any officer or employee of the firm accept liability or responsibility for any statement contained herein. The vendor does not by these particulars, nor does the firm, nor does any officer or any employee of the firm have any authority to make or give any representation or warranty whatsoever as regards the property or otherwise. It is the sole responsibility of any person interested in the property described in these particulars to make all proper enquiries and searches to verify the description of the property and all other particulars herein.

FOR MORE PROPERTIES VISIT OUR WEBSITE @ deanwood.im