



# CURZON STREET

## MAYFAIR W1J



BEAUTIFULLY RENOVATED TWO BEDROOM DUPLEX PENTHOUSE APARTMENT  
WITH A ROOF TERRACE SET WITHIN THIS SECLUDED BLOCK, WITH A LIFT  
AND CONCIERGE.



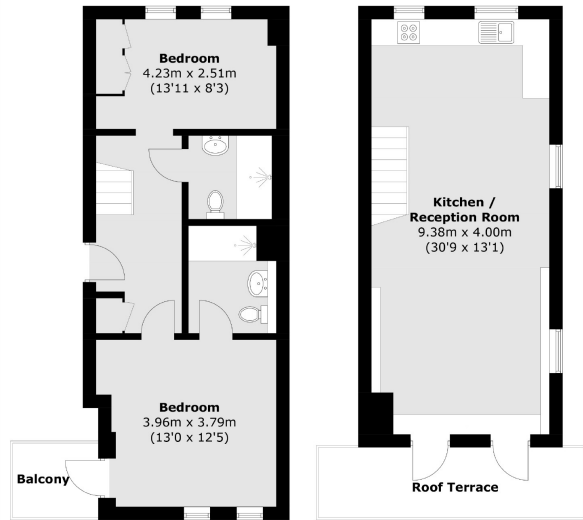

Area (approx.): 83.2 sq. m (895.5 sq. ft)  
Balcony / Roof Terrace Area : 13.0 sq. m (139.9 sq. ft)

This bright airy property offers modern style accommodation with solid wood flooring throughout, on the 5th and 6th floors, and has been finished to a high specification.

Accommodation extends to 881 sq ft with an entrance hall, principal bedroom with en-suite bathroom & feature bath and balcony, second double bedroom, luxury shower room, open tread stairs lead to a large reception/dining room with fitted open plan kitchen and access to the roof terrace.

#### FEATURES

- Two Double Bedrooms
- Penthouse Apartment
- Wooden Flooring
- Luxury Renovation
- Roof Terrace
- Lift and Concierge

Price: £1,730 Per week

We aim to make our particulars both accurate and reliable. However they are not guaranteed; nor do they form part of an offer or contract. If you require clarification on any points then please contact us, especially if you're traveling some distance to view. Please note that appliances and heating systems have not been tested and therefore no warranties can be given as to their working order. Energy Rating: C

Curzon Street is close to Shepherd's Market which contains many fine restaurants and private members clubs. Quietly located in the heart of Mayfair close to Berkeley Square and a few minutes walk to Green Park.



**WETHERELL**  
MAYFAIR'S FINEST PROPERTIES

102 Mount Street • London • W1K 2TH  
T: 020 7529 5588 E: [rentals@wetherell.co.uk](mailto:rentals@wetherell.co.uk)

[wetherell.co.uk](http://wetherell.co.uk)

NO ONE KNOWS MAYFAIR BETTER THAN WETHERELL