



## Rochester Row, SW1P

£750 Per week

A recently refurbished one double bedroom apartment with an additional study in one of Westminster's premier developments. Bright reception room with modern open plan kitchen, good size double bedroom with balcony, extra study/guest room, bathroom with shower over bath and guest wash closet. Communal heating and hot water included.

10 Rochester Row provides a residents gymnasium, porter and is within easy reach of the amenities including local shops and restaurants on Victoria Street.

### Features

- Large One Double Bedroom
- Additional Study
- Wood Floors Throughout
- Private Balcony
- Concierge & Gym
- Hot Water/Heating Included

# Rochester Row, London, SW1P

10 Rochester Row, SW1P London  
**TOTAL AREA: 65 m<sup>2</sup> - 699 ft<sup>2</sup>**

## ▼ 2nd Floor

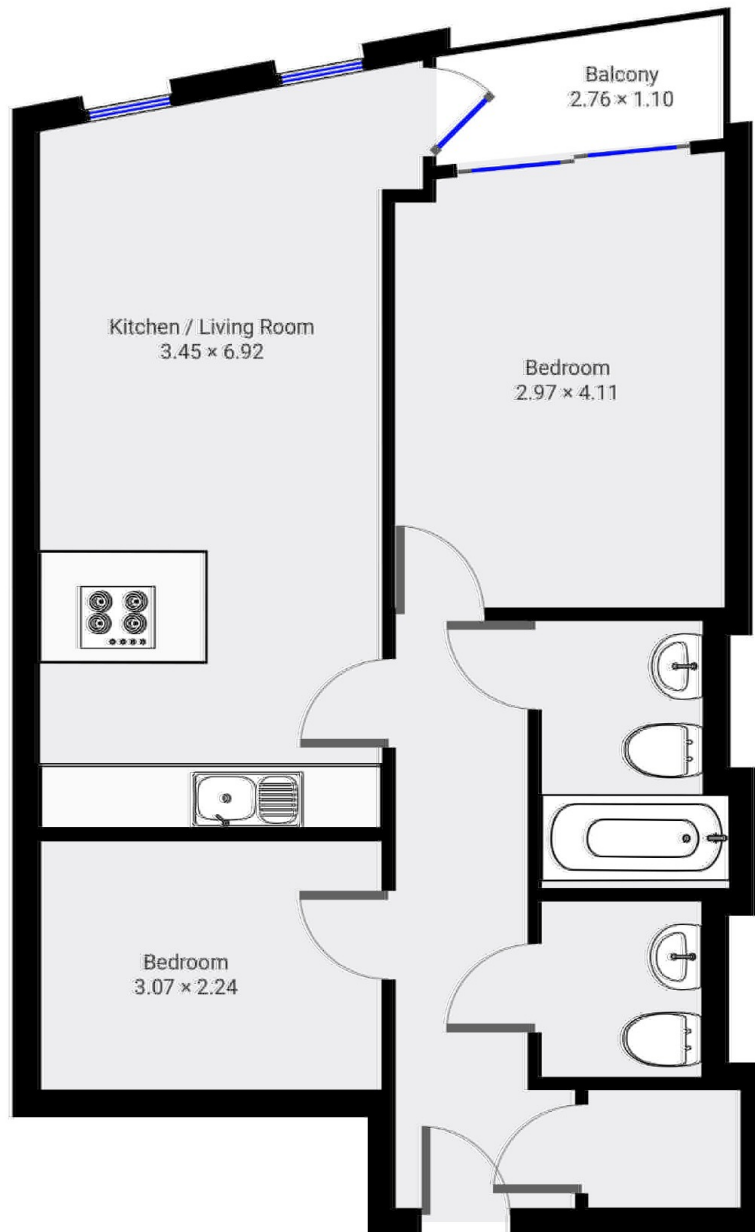

THIS FLOORPLAN IS PROVIDED WITHOUT WARRANTY OF ANY KIND. SENSOPIA DISCLAIMS ANY WARRANTY INCLUDING, WITHOUT LIMITATION, SATISFACTORY QUALITY OR ACCURACY OF DIMENSIONS.

0.0 0.5 1.0 1.5 2.0m  
1:49  
Page 2/2