



Wandsworth Road, SW8

£2,250 Per week

This ground floor two double bedroom flat comes with a reception room, separate kitchen, wooden flooring and neutral décor throughout. There is also access to communal gardens. An ideal home for professional sharers.

Ideally located with access to the areas many local shops, bars and restaurants. With Stockwell tube and Wandsworth Road stations just half a mile away.

Features

- Ground Floor Flat
- Two Double Bedrooms
- Communal Garden
- Reception Room
- Separate Kitchen
- Prime Location

Wandsworth Road,
London, SW8

Raised Ground Floor

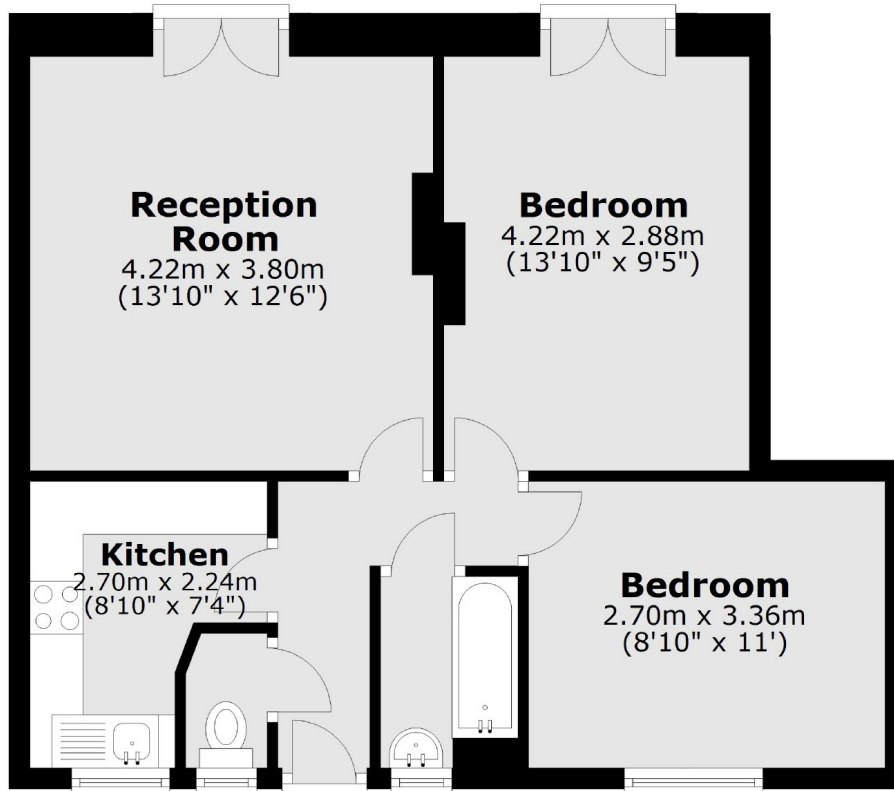

Total area: approx. 49.5 sq. metres (532.8 sq. feet)