



Tregarvon Road, SW11

£2,200 Per calendar month

A lovely one bedroom ground floor flat with wood floors, modern kitchen, dining area and a large private garden.

Situated between Lavender Hill and Clapham Common, it's a fantastic location with the options of both Clapham Junction and Clapham Common.

Features

- Period Conversion
- Separate Reception Room
- Eat-In Kitchen
- Private Garden
- Ample Storage
- Close To The Common

Tregarvon Road, London, SW11

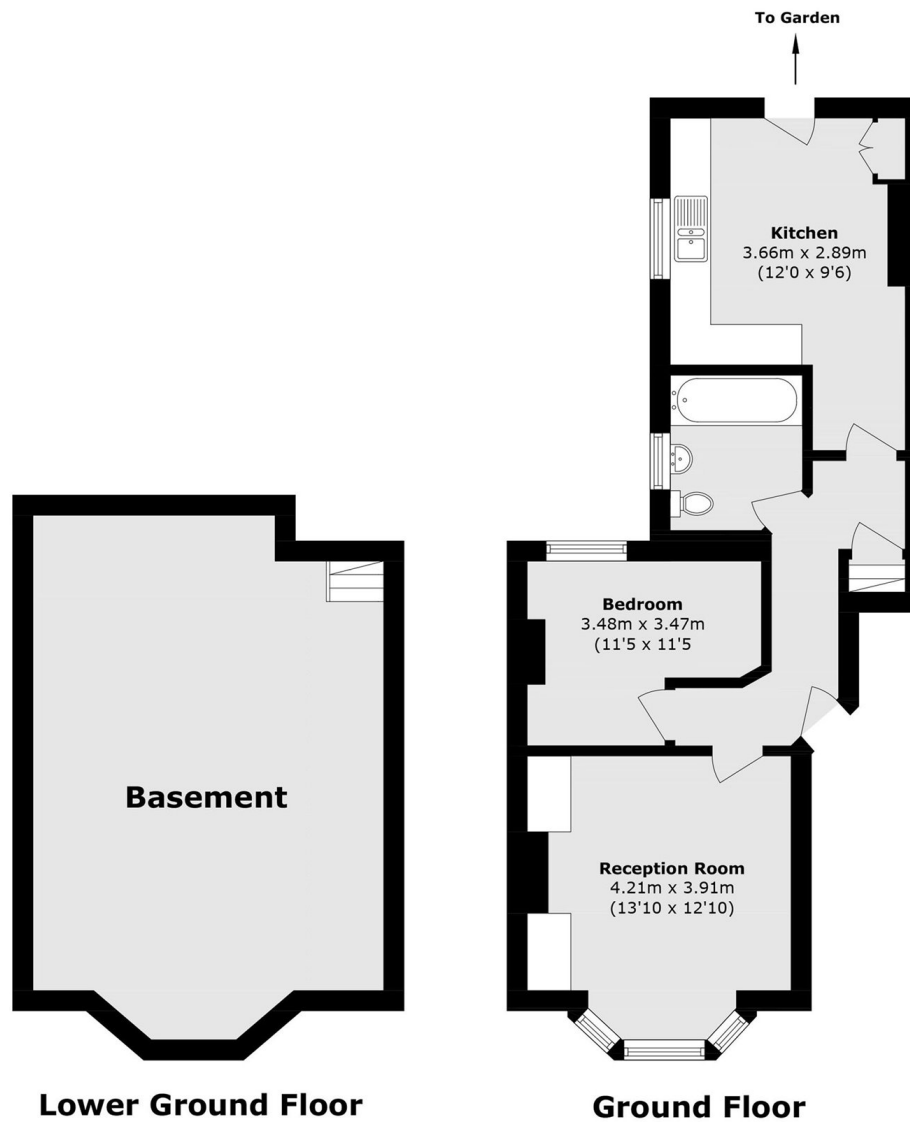

Total area (approx.): 49.1 sq. m (528.5 sq. ft)
(Excluding Basement)