

Total Area: 57.9 m² ... 623 ft²
All measurements are approximate and for display purposes only

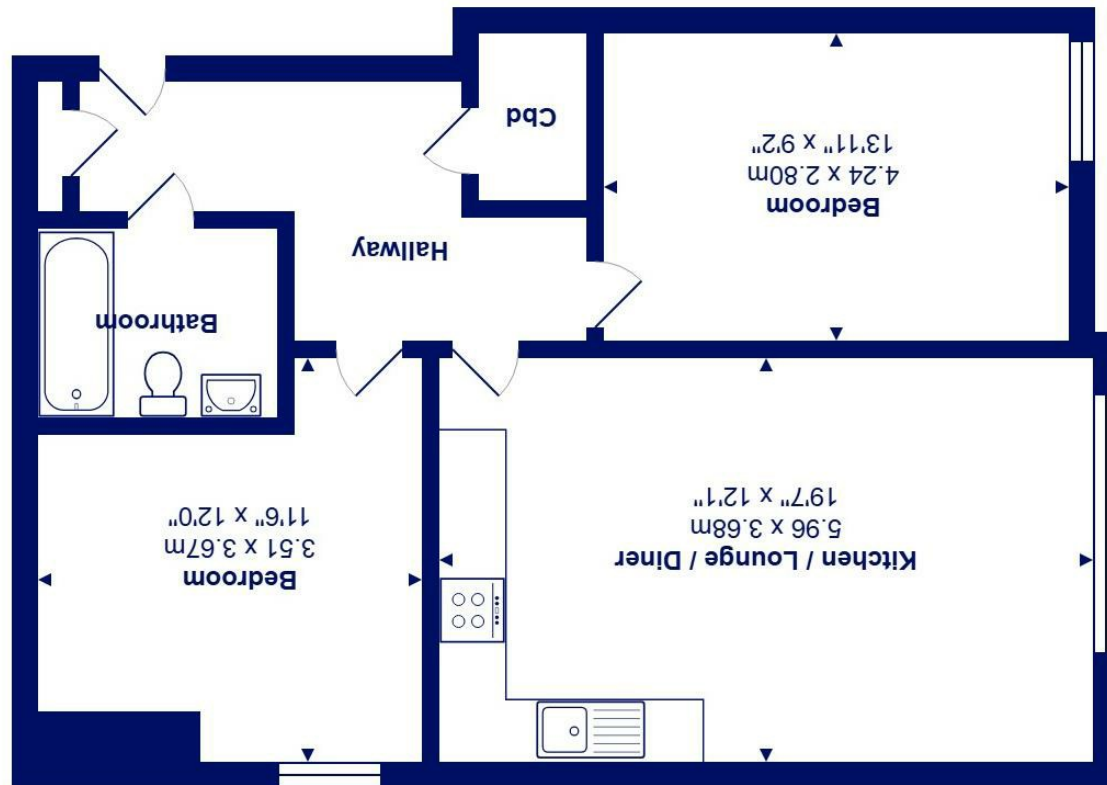

267 Lymington Road, Highcliffe On Sea, BH23 5FW £275,000

Mitchells
1963 — TODAY

A stylish two bedroom second floor apartment in this convenient development right on the high street in Highcliffe with passenger lift and allocated parking.

Built by Hoburne Developments in 2020 featuring contemporary architecture and are within a stone's throw of local amenities and just short stroll to the cliff top and the beach.

- Two good size double bedrooms
- Designer bathroom with tiling by Porcelanosa
- Gas fired central heating & Upvc double glazing
- Quality flooring throughout, Flat plastered ceilings & LED lighting
- Pet friendly subject to freeholder consent
- Allocated parking space
- Remainder of 10 Year New Home Warranty
- Lease 125 years from 2020, no ground rent payable
- Maintenance approx £1500 p/a
- Excellent location on the bustling high street and walking distance of the cliff top and beach

EPC Rating Band: B
Council Tax Band: C
Leasehold

Successful buyers will be required to complete online identity checks provided by Lifetime Legal. The cost of these checks is £45 inc. VAT per purchase which is paid in advance, directly to Lifetime Legal. This check verifies your identity in line with our obligations as stipulated by our regulatory body, HMRC

