

for sale

offers over **£425,000**



Apseleys Mead Bradley Stoke Bristol BS32 0BE

Three-Bedroom Semi-Detached Home with Garage.

A well-presented and spacious three-bedroom ideally suited to first-time buyers or investors. The property offers a bright lounge, fitted kitchen with adjoining dining room, and three well-proportioned bedrooms served by a modern shower room.



Apseleys Mead Bradley Stoke Bristol BS32 0BE

Entrance Hall

Double glazed entrance door, stairs rising to the first floor and access to the lounge.

Lounge

14' 10" x 11' 5" (4.52m x 3.48m)

A spacious reception room with double glazed window to the front aspect, useful under-stairs storage cupboard and doorway leading to the kitchen.

Kitchen

10' 2" x 11' 5" (3.10m x 3.48m)

Fitted with a range of wall and base units with work surfaces

over, space for appliances and opening through to the dining room.

Dining Room

10' 2" x 7' 3" (3.10m x 2.21m)

A versatile space ideal for family dining, with double glazed French doors opening onto the rear garden.

Landing

Providing access to all bedrooms and the shower room. Airing cupboard housing hot water tank.



Bedroom One

14' 1" x 8' 3" (4.29m x 2.51m)

A good-sized double bedroom with double glazed window to the front aspect.

Bedroom Two

11' 3" x 8' (3.43m x 2.44m)

A well-proportioned bedroom with double glazed window to the rear aspect.

Bedroom Three

9' 5" x 6' 4" (2.87m x 1.93m)

A single bedroom ideal as a child's room, nursery, home office or study.

Shower Room

6' 5" x 5' 7" (1.96m x 1.70m)

Fitted with a shower enclosure, wash hand basin and low-level WC, with obscured double glazed window to the rear aspect.

Rear Garden

An enclosed rear garden offering space for outdoor seating and entertaining. There are also 2 large ponds.



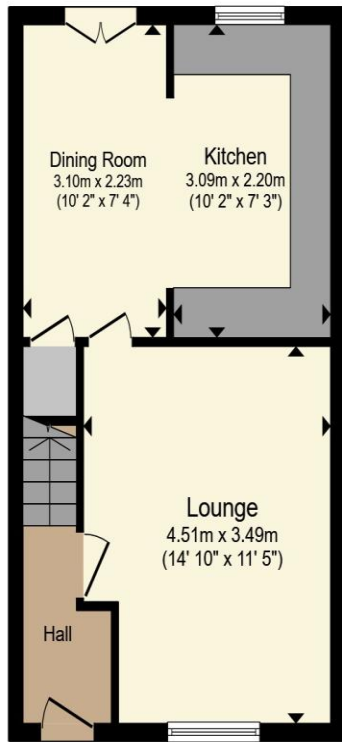

Ground Floor

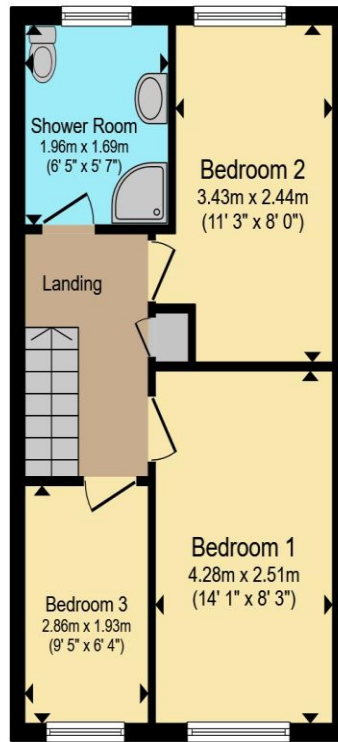

First Floor

Total floor area 76.8 m² (827 sq.ft.) approx

This floor plan is for illustrative purposes only. It is not drawn to scale. Any measurements, floor areas (including any total floor area), openings and orientation are approximate. No details are guaranteed, they cannot be relied upon for any purpose and they do not form part of any agreement. No liability is taken for any error, omission or misstatement. A party must rely upon its own inspection(s). Powered by www.propertybox.io



To view this property please contact Connells on

T 0117 956 9555
E emersonsgreen@connells.co.uk

2 The Village Emerson Way Emersons Green
 BRISTOL BS16 7AE

Property Ref: EME307168 - 0004

Tenure:Freehold EPC Rating: C

Council Tax Band: C

view this property online
connells.co.uk/Property/EME307168

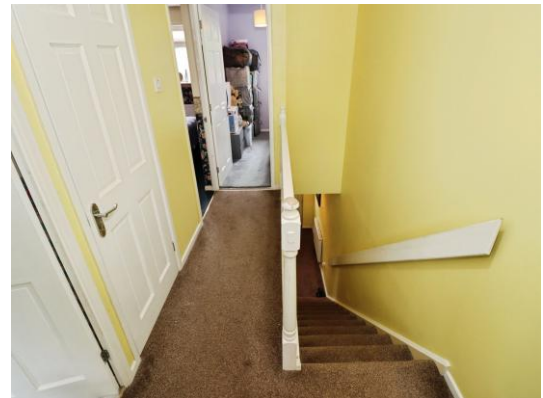

1. MONEY LAUNDERING REGULATIONS Intending purchasers will be asked to produce identification documentation at a later stage and we would ask for your co-operation in order that there will be no delay in agreeing the sale. 2. These particulars do not constitute part or all of an offer or contract. 3. The measurements indicated are supplied for guidance only and as such must be considered incorrect. Potential buyers are advised to recheck measurements before committing to any expense. 4. We have not tested any apparatus, equipment, fixtures, fittings or services and it is in the buyers interest to check the working condition of any appliances.

Connells Residential is registered in England and Wales under company number 1489613, Registered Office is Cumbria House, 16-20 Hockliffe Street, Leighton Buzzard, Bedfordshire, LU7 1GN. VAT Registration Number is 500 2481 05.

see all our properties at www.connells.co.uk | www.rightmove.co.uk | www.zoopla.co.uk