

TO LET



**Church Street Apartments,
Westbury**

**1 Bedroom, 1 Bathroom, First Floor
Apartment**

£750 pcm



**Church Street
Apartments, Westbury**
First Floor Apartment,
1 bedroom, 1 bathroom

£750 pcm

Date available: 1st June
2026

Deposit: £865

Holding deposit: £170

Unfurnished

Council Tax band: A

- One bedroom first floor apartment
- Good size living room
- Bathroom
- Fitted kitchen
- Electric storage heating
- Allocated parking for one car
- Excellent location in town centre

A one bedroom, first floor apartment excellently located in the town centre. Benefitting from its own private access door and allocated parking for one car.

Energy Efficiency Rating		
	Current	Potential
Very energy efficient - lower running costs		
(92 plus) A		
(81-91) B		
(69-80) C		
(55-68) D	67	73
(39-54) E		
(21-38) F		
(1-20) G		
Not energy efficient - higher running costs		
England & Wales	EU Directive 2002/91/EC	

Environment Impact (CO ₂) Rating		
	Current	Potential
Very environmentally friendly - lower CO ₂ emissions		
(92 plus) A		
(81-91) B		
(69-80) C		
(55-68) D	60	62
(39-54) E		
(21-38) F		
(1-20) G		
Not environmentally friendly - higher CO ₂ emissions		
England & Wales	EU Directive 2002/91/EC	

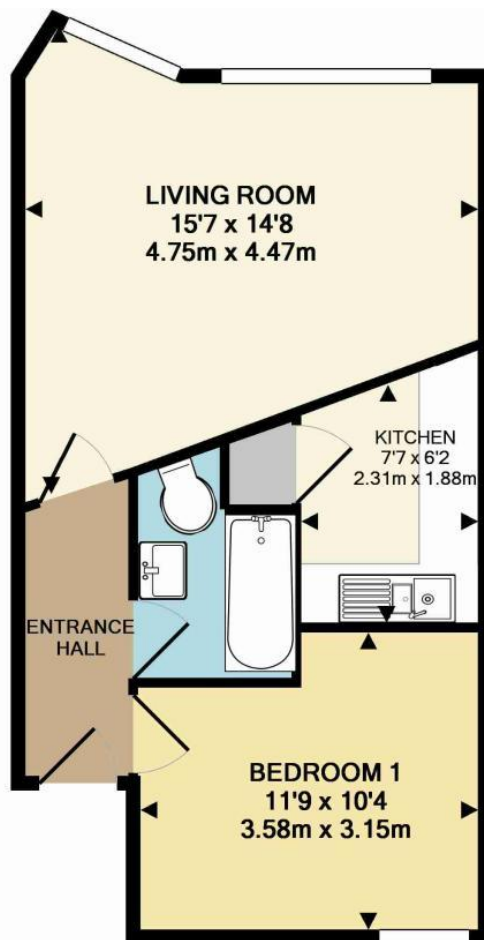

TOTAL APPROX. FLOOR AREA 432 SQ.FT. (40.1 SQ.M.)

Whilst every attempt has been made to ensure the accuracy of the floor plan contained here, measurements of doors, windows, rooms and any other items are approximate and no responsibility is taken for any error, omission, or mis-statement. This plan is for illustrative purposes only and should be used as such by any prospective purchaser. The services, systems and appliances shown have not been tested and no guarantee as to their operability or efficiency can be given.
Made with Metropix ©2016

Martin & Co Westbury
7 Palomino Place • Westbury • Wiltshire • BA13 3SD
T: 01373 866686 • E: westbury@martinco.com

01373 866686
<http://www.martinco.com>



Accuracy: References to the Tenure of a Property are based on information supplied by the Seller. The Agent has not had sight of the title documents. A Buyer is advised to obtain verification from their Solicitor. Items shown in photographs including but not limited to carpets, fixtures and fittings are not included unless specifically mentioned within the sales particulars. They may however be available by separate negotiation. Buyers must check the availability of any property and make an appointment to view before embarking on any journey to see a property. No person in the employment of the agent has any authority to make any representation about the property, and accordingly any information given is entirely without responsibility on the part of the agents, sellers(s) or lessors(s). Any property particulars are not an offer or contract, nor form part of one. **Sonic / Laser Tape:** Measurements taken using a sonic / laser tape measure may be subject to a small margin of error. **All Measurements:** All Measurements are Approximate. **Services Not tested:** The Agent has not tested any apparatus, equipment, fixtures and fittings or services and so cannot verify that they are in working order or fit for the purpose. A Buyer is advised to obtain verification from their Solicitor or Surveyor.

