



enfields

Enfields Rythe
3 Marsh Park
Rythe, Southampton
SO45 6AA
T 023 9084 9210
E sales-rythe@enfields.co.uk

Hillview Road, Hythe, SO45

Guide Price £375,000

🛏️ 4 🚿 1 🚻 3



- Being Sold via Secure Sale online bidding. Terms & Conditions apply. Starting Bid £400,000
- Being Sold via 'Secure Sale'
- Immediate 'Exchange Of Contracts' Available
- Four Bedroom Detached Chalet
- Driveway And Garage
- No Forward Chain
- Potential to Extend (STPP)
- Popular Location
- Private Rear Garden
- Living Room And Separate Dining Room



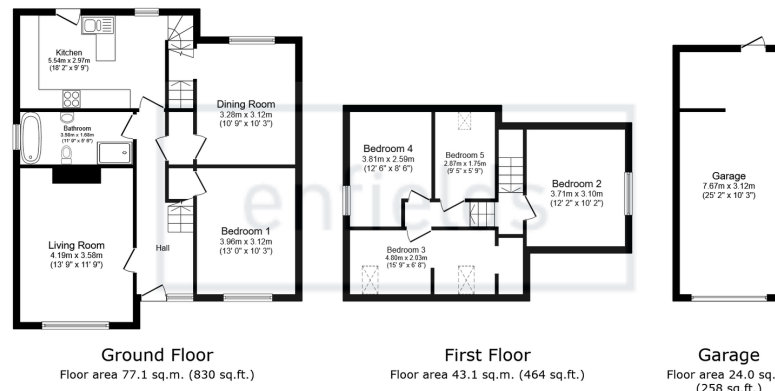

Total floor area: 144.2 sq.m. (1,552 sq.ft.)

This floor plan is for illustrative purposes only. It is not drawn to scale. Any measurements, floor areas (including any total floor area), openings and orientations are approximate. No details are guaranteed, they cannot be relied upon for any purpose and do not form any part of any agreement. No liability is taken for any error, omission or misstatement. A party must rely upon its own inspection(s). Powered by www.Propertybox.io



Being Sold via Secure Sale online bidding. Terms & Conditions apply. Starting Bid £375,000

Enfields are pleased to offer to the market this split-level detached chalet bungalow with four bedroom, three reception rooms, driveway and garage, available for sale with no forward chain.

www.enfields-southampton.co.uk



It is Enfields policy to respect any sole agency currently in force and we would not be able to commence marketing until this has expired or been terminated. If you fail to terminate any previous agreement you could be liable for two sets of fees. Enfields Hythe is a trading name of YTF LTD Registered office: 345 Shirley Road, Southampton, Hampshire, England, SO15 3JD. Company Registration No: 10459987. VAT Registration No: 281 2975 81.

Enfields Lettings - Embley Management LTD T/A Enfields. Registered Address: 345 Shirley Road, Southampton, Hampshire, England, SO15 3JD. Company Registration No: 14847604. VAT Registration No: 439 8546 45.