



jordan fishwick

ALTRINCHAM
York Road



York Road, Altrincham, WA14 3EQ

Asking Price £575,000



The Property

Located in the desirable Bowdon Vale village area, this stunning and characterful Victorian end-terrace property occupies a prime position on the highly sought-after York Road.

The property is ideally situated close to highly regarded schools, local amenities, and Bowdon Cricket and Hockey Clubs, while also offering convenient access to nearby motorway links.

In brief, the accommodation comprises an inviting entrance hall providing access to a bay-fronted lounge and an extended open-plan kitchen diner. The kitchen features a breakfast island, Velux windows, and bi-fold doors opening onto the rear yard, creating a bright and sociable living space. Stairs from the kitchen diner lead down to the converted basement, which offers a double bedroom and a home cinema room.

To the first floor, there are two further well-proportioned double bedrooms and a family bathroom. The property retains a wealth of period features throughout, including original solid wood flooring in the majority of rooms.

Externally, there is a private, decked rear yard which acts as a suntrap, along with off-road parking to the front of the property.

Early viewing is strongly advised to fully appreciate the charm and quality of this exceptional home.

Directions

WA14 3EQ



- Immaculately presented throughout
- Stunning period features
- Extended Kitchen Diner
- Converted Basement with Bedroom and Cinema Room
- Off Road Parking
- Rear yard
- Three Double Bedrooms
- Walking distance to local amenities
- Freehold
- End of Terrace

Postcode - WA14 3EQ

EPC Rating - D

Floor Area - 1660.00 sq ft

Local Authority - Trafford

Council Tax - E



York Road, Bowdon

Total Approx. Floor Area 1660 Sq.ft. (154.2 Sq.M.)

Surveyed and drawn by Lens Media for illustrative purposes only. Not to scale. Whilst every attempt was made to ensure the accuracy of the floor plan, all measurements are approximate and no responsibility is taken for any error.

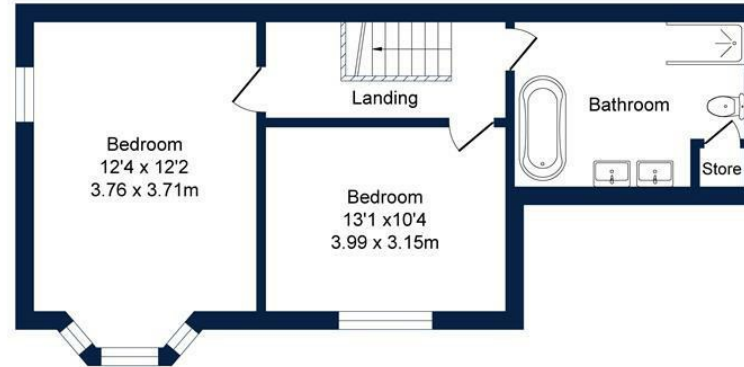

First Floor
Approx. Floor Area 534 Sq.Ft (49.6 Sq.M.)



Lower Ground Floor
Approx. Floor Area 437 Sq.Ft (40.6 Sq.M.)

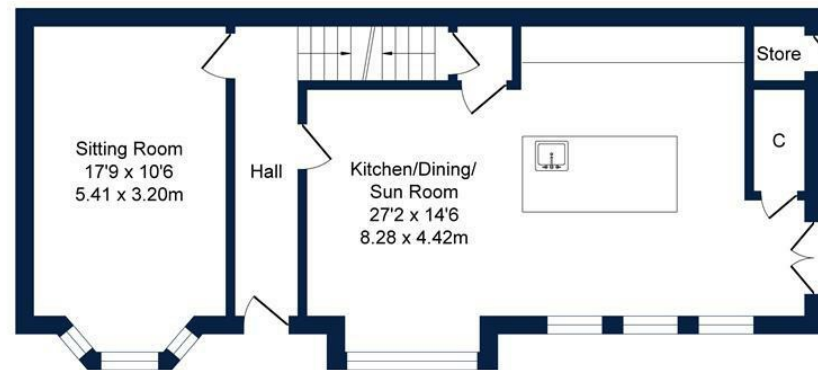

Ground Floor
Approx. Floor Area 689 Sq.Ft (64.0 Sq.M.)



These particulars are believed to be accurate but they are not guaranteed and do not form a contract. Neither Jordan Fishwick nor the vendor or lessor accept any responsibility in respect of these particulars, which are not intended to be statements or representations of fact and any intending purchaser or lessee must satisfy himself by inspection or otherwise as to the correctness of each of the statements contained in these particulars. Any floorplans on this brochure are for illustrative purposes only and are not necessarily to scale.

Offices at: Chorlton, Didsbury, Disley, Hale, Glossop, Macclesfield, Manchester Deansgate, Manchester Whitworth Street, New Mills, Sale, Wilmslow and Withington

0161 929 9797

hale@jordanfishwick.co.uk
www.jordanfishwick.co.uk