



## PORTOBELLO ROAD, W11

£2,816 per month

This fantastic one bedroom apartment has been recently refurbished to a very high standard throughout.

Bright one bedroom  
Well presented  
High ceilings

Iconic location  
Wood floors  
EPC - C

# STEP INSIDE PORTOBELLO ROAD

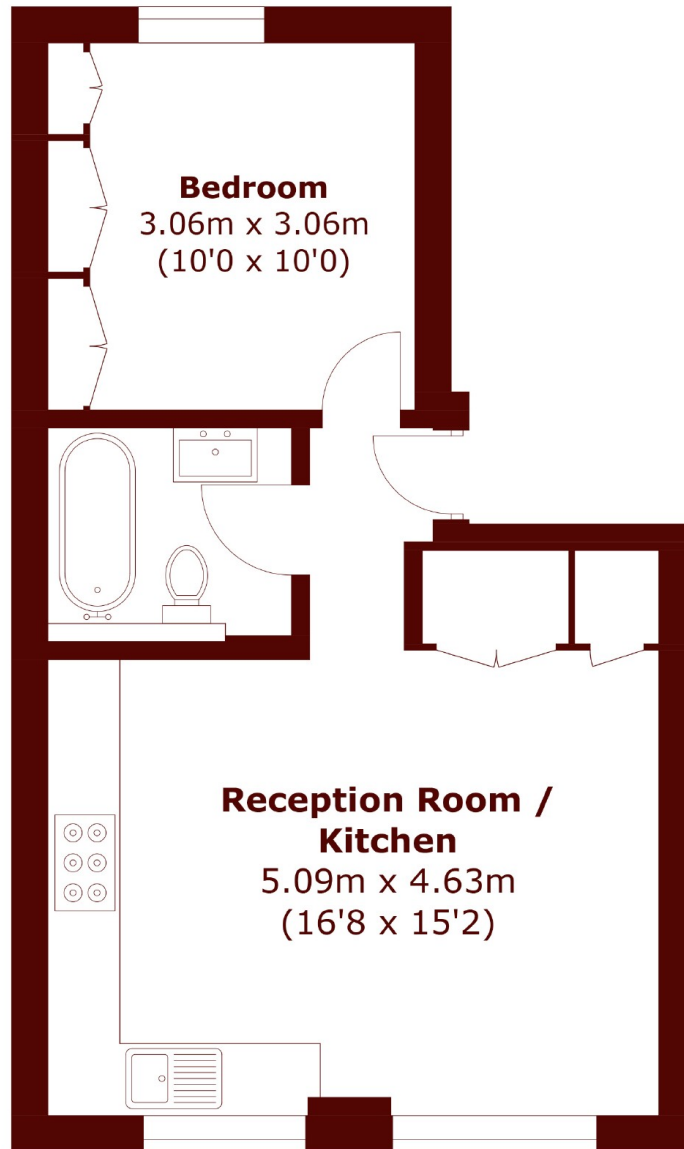

Total area (approx.): 37.2 sq. m (400.4 sq. ft)

**Notting Hill**  
020 7313 6910

Energy Rating: C We aim to make our particulars both accurate and reliable. However, they are not guaranteed; nor do they form part of an offer or contract. If you require clarification on any points then please contact us, especially if you're traveling some distance to view. Please note that appliances and heating systems have not been tested and therefore no warranties can be given as to their good working order

**MARSH &  
PARSONS**