



## Flat 2 Arley House 5 Hanley Terrace, Malvern, WR14 4PF **£775 Per Month**

A beautifully presented spacious one bedroom, ground floor apartment with views across the Severn Valley. The accommodation comprises; open plan kitchen/living room with breakfast bar, Belfast sink, electric hob, oven, dishwasher, fridge & washing machine, feature fire place with electric fire, double bedroom with walk in cupboard with hanging rails ( this cupboard also houses the boiler), fully tiled bathroom with WC, wash hand basin and walk in shower. The property benefits from gas fired central heating. EPC rating C, council tax band A, deposit £894, holding deposit £178. Available mid July.



# Flat 2 Arley House, 5 Hanley Terrace, Malvern, WR14 4PF

## Information

### TENANT FEES:

**HOLDING DEPOSIT:** A refundable\* holding fee equivalent to one week's rent (£178) is payable in advance in order to reserve the property. The holding fee will be deducted from the first month's rent payment. \*Conditions apply

**DEPOSIT:** A deposit of £894 will be required as security against damage or arrears of rent.

**RENT:** £775 Per calendar month.

**FURNISHINGS:** The property is offered to let unfurnished

**RESTRICTIONS:** Non-smokers only. No pets due to headlease of building and block management company not allowing pets

**TERM:** Six months minimum. A longer term may be available by negotiation.

**APPLICATION:** You must complete an application form and online referencing form. This must be completed and returned promptly. Photographic ID (passport) and a current proof of address will be required by all applicants  
The property will remain on the market until satisfactory referencing has been received from our referencing company.

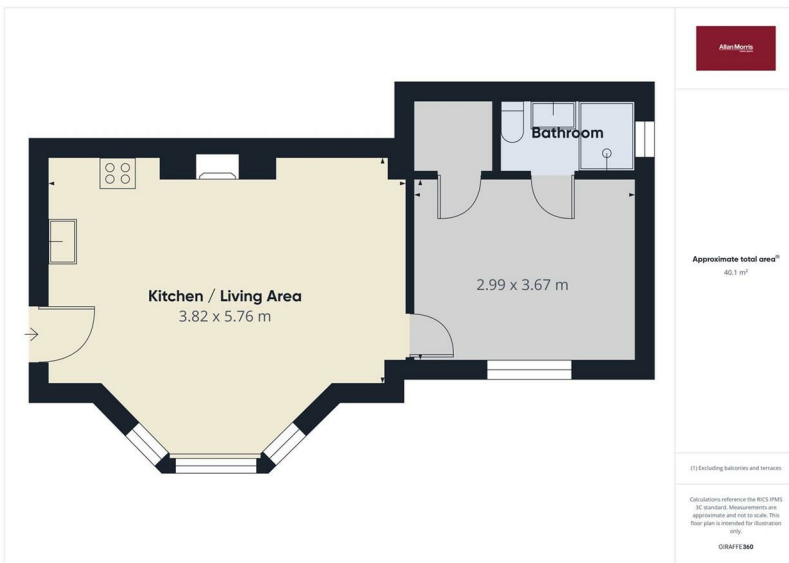

### EPC

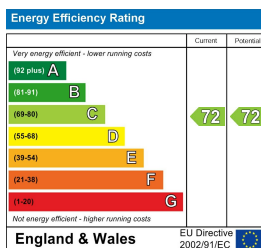

### Material Information Report

