

COCKBURN
ESTATE AND LETTINGS AGENTS

Sidcup Road

SE9 3AF

FOR SALE
COCKBURN
020 8859 8590



***** CHAIN FREE SALE *****

Introducing a fantastic opportunity to transform a property into your dream family home at Sidcup Road, Mottingham.

This spacious property spans over 1032 sq ft, boasting one large through reception/dining room, fitted kitchen, three well proportioned bedrooms and family bathroom. Enjoy outdoor living in the generously sized rear garden – complete with both decked area and lawned green, a perfect oasis for relaxation and recreation.

Unlock the property's full potential with the possibility to extend both to the rear and into the loft, subject to the necessary planning permissions, customizing the space to suit your family's unique needs and lifestyle. Convenience is key, and this property offers off-street parking for multiple vehicles, ensuring secure and hassle-free parking for your vehicles.

Located within a stone's throw of Mottingham Railway Station and well-connected bus links, commuting is a breeze, providing easy access to the heart of London and beyond. Enjoy the convenience of excellent local amenities, including shops and eateries within close reach. Everything you need is right at your doorstep.

The property is situated in a great catchment area for highly regarded schools, making it an ideal choice for growing families seeking quality education for their children.

Don't miss out on the chance to make Sidcup Road your dream residence. Contact us today to schedule a viewing and explore the potential of this remarkable family home.



Key Features:

- ❑ Chain Free Sale
- ❑ Three Bed Family Home
- ❑ Large Through Reception/Dining Room
- ❑ Off Street Parking For Multiple Vehicles
- ❑ Generous Well Maintained Garden To Rear
- ❑ Potential To Extend STPP
- ❑ Stones Throw Of Mottingham Railway Station
- ❑ Excellent Local Amenities Including Shops & Eateries
- ❑ Great Catchment Area For Highly Regarded Schools
- ❑ Council Tax Band D - Royal Borough Of Greenwich



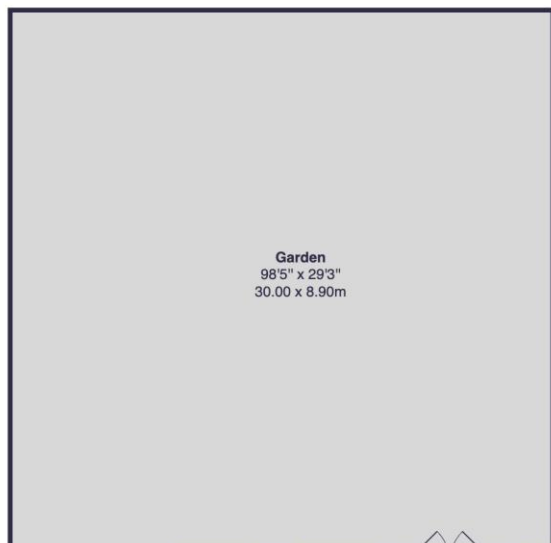

Sidcup Road, SE9

Approximate Gross Internal Area:
1032 sq ft / 95.9 sq m

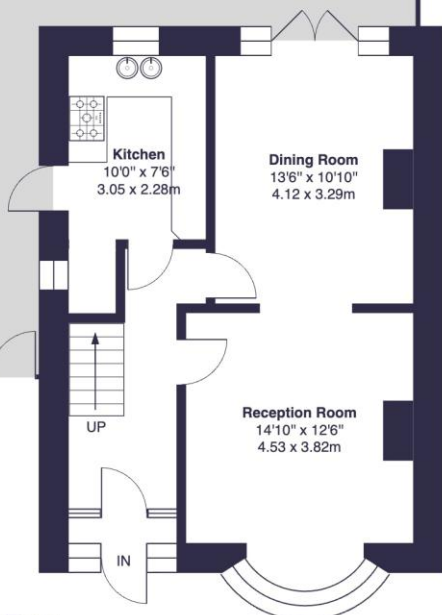

Ground Floor

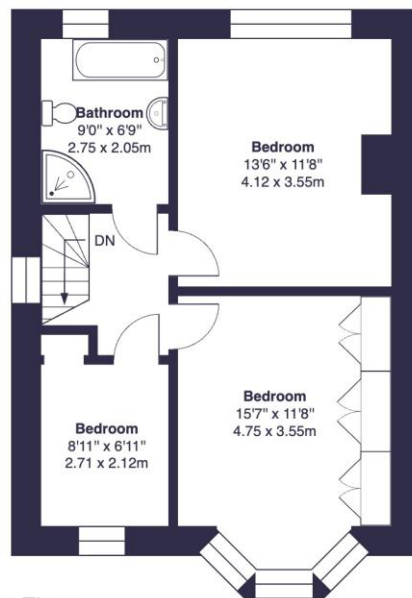

First Floor

EPC: D

COUNCIL TAX BAND: D

TENURE: Freehold

For more information on this property or to arrange a viewing please call the office on

0208 859 8590

Alternatively, you can scan below to view all of the details of the property online.



352 Footscray Road
New Eltham
London
SE9 2EB

This floor plan was produced using RICS measurements standards 2nd edition.
For layout guidance only and not drawn to scale unless stated. Window and door openings are approximate.
Whilst every care is taken in the preparation of this plan, we would advise interested parties to check all dimensions, shapes and compass bearings prior to making any decisions reliant upon them. No liability is accepted for any errors.
By www.primesquarephotography.com / Copyright 2026