



## OLD COURT PLACE, W8

£775 per week

One Bedroom  
One Bathroom  
Wooden Floors Throughout  
Modern Separate Kitchen  
Lift and Porter  
Great Kensington Location

@marshandparsons  
marshandparsons.co.uk

MARSH &  
PARSONS



# ABOUT THE PROPERTY

This apartment offers incredible living space with room for dining and benefits from a separate kitchen with integrated appliances as well as, a large double bedroom that has ample storage.

Old Court House is ideally located on Kensington High Street with immediate access to the tubes at High Street Kensington (Circle & District lines) as well as the numerous bus links. The open spaces of Kensington Gardens are also a stone's throw as are the boutique shops and cafes of Kensington Church Street.



# STEP INSIDE OLD COURT PLACE

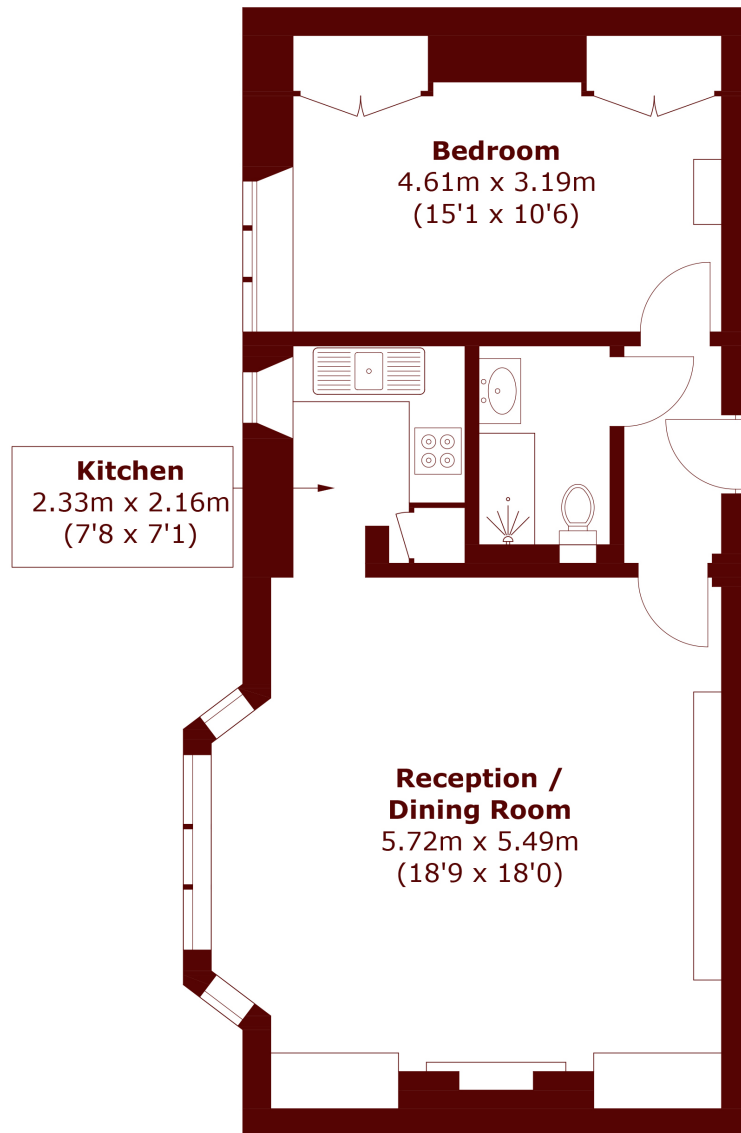

## Third Floor

Total area (approx.): 56.6 sq. m (609.2 sq. ft)

**Kensington**  
020 7368 4460

Energy Rating: We aim to make our particulars both accurate and reliable. However, they are not guaranteed; nor do they form part of an offer or contract. If you require clarification on any points then please contact us, especially if you're traveling some distance to view. Please note that appliances and heating systems have not been tested and therefore no warranties can be given as to their good working order

**MARSH &  
PARSONS**