



## Liphook Crescent, SE23

£975,000

A rare opportunity to transform this substantial four bedroom 1930s detached home, complete with a south east facing garden and off street parking. Offering generous proportions and huge potential in a desirable location.

Liphook Crescent is ideally positioned in the heart of Forest Hill, just a short walk from Forest Hill and Honor Oak Park stations, providing swift connections to London Bridge and Canada Water. Residents enjoy easy access to the open green spaces of Horniman Gardens and Blythe Hill Fields, as well as the independent cafés, shops and everyday amenities of Forest Hill and Honor Oak, with a selection of highly regarded schools nearby.

### Features

- Detached House
- Four Bedrooms
- Two Bathrooms
- South East Facing Garden
- Off Street Parking
- In Need Of Modernisation

# Liphook Crescent, London, SE23

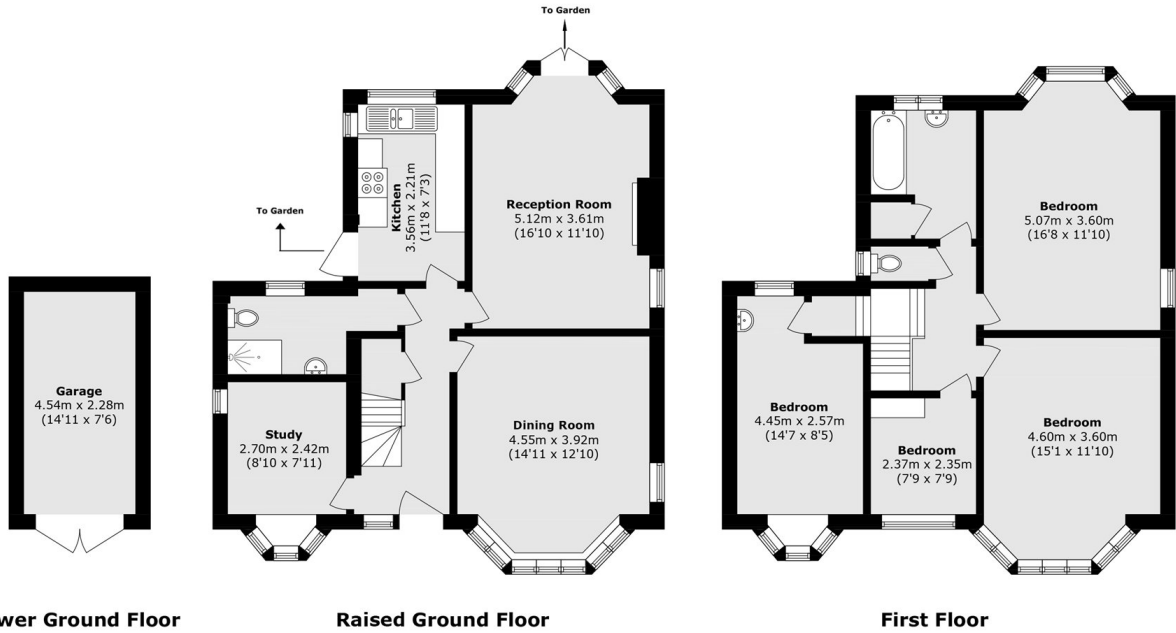

Total area (approx.): 130.0 sq. m (1399.3 sq. ft)  
(Excluding Garage)  
Garage area (approx.): 10.3 sq. m (110.8 sq. ft)