



Harewood Avenue, NW1

£2,275 Per calendar month

A bright and well proportioned one bedroom flat with additional study/office room, close to Marylebone Station.

Wimborne House is ideally located on Harewood Avenue, moments from Marylebone Station and within easy reach of Regent's Park, as well as the shops, cafés and restaurants of Marylebone.

Features

- Recently Decorated
- One Double Bedroom Flat
- Additional Study/Office Room
- Large Reception Room
- Private Patio Garden
- Close To Marylebone

Harewood Avenue, London, NW1

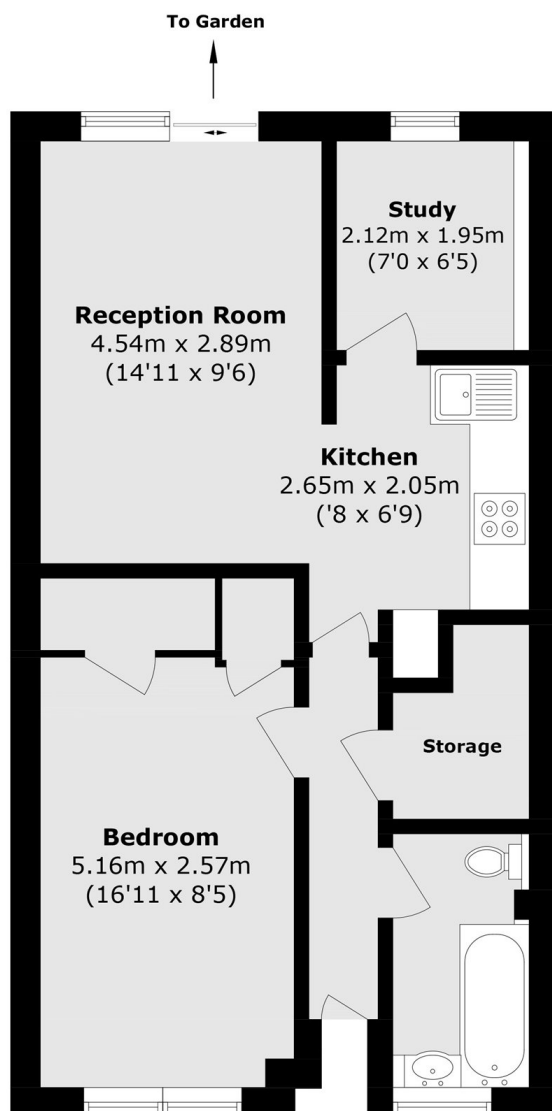

Total area (approx.): 47.1 sq. m (506.9 sq. ft)