



JOSHUA JAMES

ESTATE AGENTS

Chapel Field, Gamlingay SG19 3QP

£595,000

🛏️ 4 🚿 3 🚗 3

- Executive Detached Family Home
- Large Conservatory
- Bedroom Five / Office with En-Suite
- Master Bedroom with En-Suite Shower Room
- Enclosed Rear Garden with Summerhouse & Large Shed
- Separate Reception Rooms
- Fitted Kitchen & Utility Room
- Four Double Bedrooms
- Four Piece Family Bathroom Suite
- Off Road Parking & Single Garage



A well presented detached family home, offering four spacious bedrooms, three reception rooms, and three bathrooms, nestled in the desirable SG19 3QP area. This property boasts versatile living spaces, including a generous conservatory, a well-appointed kitchen with an integral double oven, and a highly adaptable ground floor bedroom / office with its own en-suite. The enclosed rear garden provides a private sanctuary with a summerhouse and large shed, complemented by off-road parking and a single garage, presenting an ideal family residence.

The double garage has been part converted to create an additional bedroom / reception room with it's own en-suite shower room. Ideal for multi generational living.



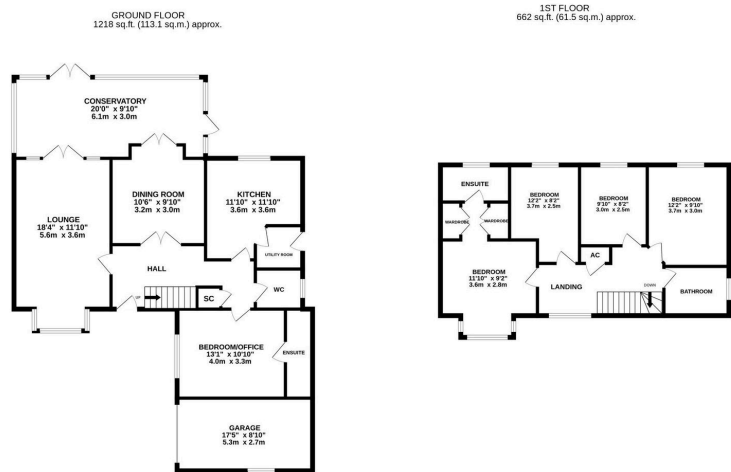

TOTAL FLOOR AREA: 1880 sq.ft. (174.7 sq.m.) approx.

Whilst every attempt has been made to ensure the accuracy of the European Standard form, measurements of floor, window, rooms and any other items are approximate and no responsibility is taken for any error, omission or mis-statement. This plan is for illustrative purposes only and should be used as such by any prospective purchaser. The services, systems and appliances shown hereon are based on our guarantees as to their operability or efficiency can be given. Made with Metrepro CDS2.