



## Fernholme Road, SE15

£2,300 Per calendar month

A stunning two double bedroom ground floor flat on Fernholme Road with a generous private south-west facing garden.

Positioned at the front of the property are two spacious double bedrooms, both benefiting from good proportions and natural light. Moving through the flat, the reception room provides a welcoming living space, enhanced by a charming bay window that draws in an abundance of light from the side return. The kitchen is thoughtfully arranged and provides direct access to the garden. The impressive south-west facing garden is a standout feature, enjoying plenty of sunlight throughout the day. It offers a mix of mature planting, a well-maintained lawn, and a decked area to the rear. Located at the rear of the property is a fully fitted bathroom

Perfectly positioned for both Nunhead and Honor Oak Park stations, with frequent services to Victoria, Blackfriars, City Thameslink, Farringdon and St Pancras. The open green spaces of Peckham Rye Park and the natural beauty of Nunhead Cemetery are also within easy reach.

### Features

Character Features  
Two Double Bedrooms  
Excellent Transport Links  
Unfurnished  
Private Garden  
Light & Airy

Fernholme Road,  
London, SE15

**Ground Floor**

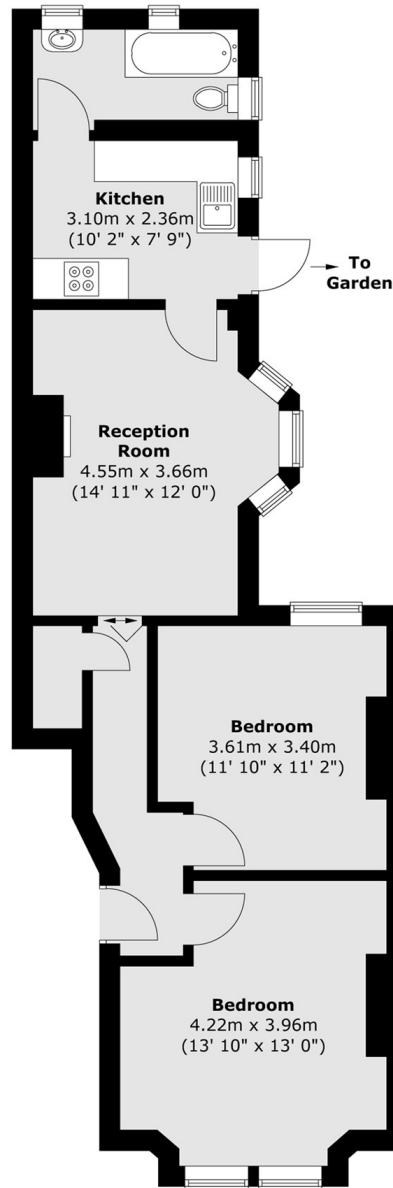

Total area (approx.) : 61.9 sq. m (666 sq. ft)