



## MOUNT NOD ROAD, SW16

£650,000

Victorian maisonette  
Ground floor flat  
Four bedrooms  
Private gardens  
Recently refurbished  
EPC: D

@marshandparsons  
marshandparsons.co.uk

MARSH &  
PARSONS



# ABOUT THE PROPERTY

A four bedroom, ground floor Victorian maisonette with a modern fitted kitchen, large family bathroom and private garden. Recently refurbished and located within very close proximity to Streatham Hill.

Mount Nod Road is a quiet and sought-after residential street situated in the Leigham Hall conservation area (ABC roads) and is within walking distance of both Streatham Hill and Tulse Hill mainline stations.



# STEP INSIDE MOUNT NOD ROAD

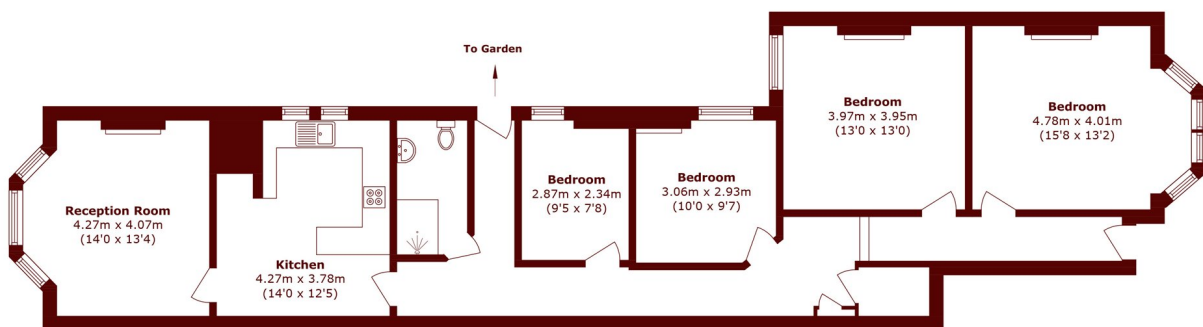

Total area (approx.): 114.2 sq. m (1229.2 sq. ft)

**Streatham**  
020 8671 0171

Energy Rating: D We aim to make our particulars both accurate and reliable. However, they are not guaranteed; nor do they form part of an offer or contract. If you require clarification on any points then please contact us, especially if you're traveling some distance to view. Please note that appliances and heating systems have not been tested and therefore no warranties can be given as to their good working order

**MARSH &  
PARSONS**