

24 Barsbank Lane,

£350,000

🛏 3 🚿 1 🚗 1



Impeccably refurbished, this **three-bedroom semi-detached family home** is located in a sought-after area just moments from Lymm village centre and its amenities.

The property boasts an open-plan kitchen and dining space with quartz worktops, a central island with oak worktop with an over hang for seating, while the lounge features a log burner. There is also a practical utility room and a contemporary downstairs cloakroom.

On the first floor, three generously proportioned bedrooms with vaulted ceilings are filled with natural light, complemented by a refitted family bathroom with designer touches.

Externally, the home offers a private, fully enclosed rear garden with paved patios, a lawn, and mature fruit trees, along with a gravel driveway providing convenient off-road parking for two vehicles.

The property is offered as freehold, and internal viewing is highly recommended.

Key Features

- Fully refurbished three-bedroom semi-detached family home
- Lounge with log burner
- Three generously proportioned bedrooms
- Private, fully enclosed rear garden
- FREEHOLD
- Stylish open-plan kitchen and dining room
- Contemporary downstairs cloakroom
- Re-fitted family bathroom
- Driveway for two vehicles
- Internal viewings essential

GROUND FLOOR
479 sq.ft. (44.5 sq.m.) approx.

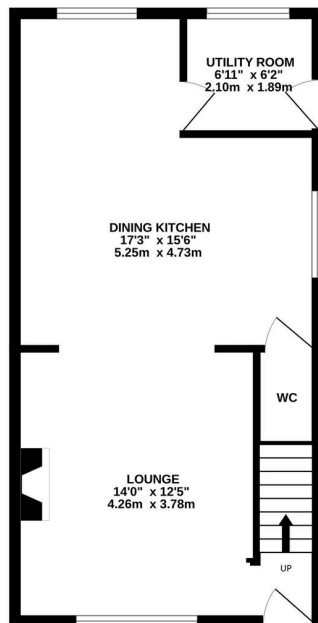

1ST FLOOR
372 sq.ft. (34.6 sq.m.) approx.

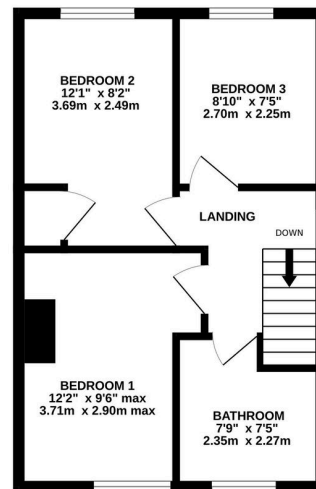

TOTAL FLOOR AREA - 851 sq.ft. (79.1 sq.m.) approx.

Whilst every attempt has been made to ensure the accuracy of the floorplans contained here, measurements of doors, windows, rooms and any other items are approximate and no responsibility is taken for any error, omission or misstatements. This plan is for illustrative purposes only and should be used as such by any prospective purchaser. The services, systems and appliances shown have not been tested and no guarantee as to their operability or efficiency can be given.
Made with Metropix 02026