



A two bedroom ground floor apartment within walking distance of local amenities
Lime Tree Court ,Hatch End, HA5 4UX



Asking Price: £1,850 pcm

A two bedroom ground floor apartment within walking distance of local amenities

Lime Tree Court ,Hatch End, HA5 4UX

Description

Two bedroom, two bathroom, ground floor apartment situated in a superb location for local schools and transport links. This spacious apartment is located on the ground floor and comprises of a hallway, fitted kitchen, bright and airy living room, en-suite shower room to master bedroom, second bedroom and family bathroom suite. The property benefits from permit parking at the rear of the property and communal gardens.

**** An advance reservation payment of one weeks rent is required to secure the property ****

Location

The Avenue is located just off the Uxbridge Road roundabout opposite Morrisons supermarket. Hatch End train station and a host of eateries are all within walking distance





Additional Information

- Council Tax Band: D
- Deposit Amount: £2,134.00
- Reservation Payment:
- Energy Efficiency Rating: Band C
- Available Date: 03/07/2026

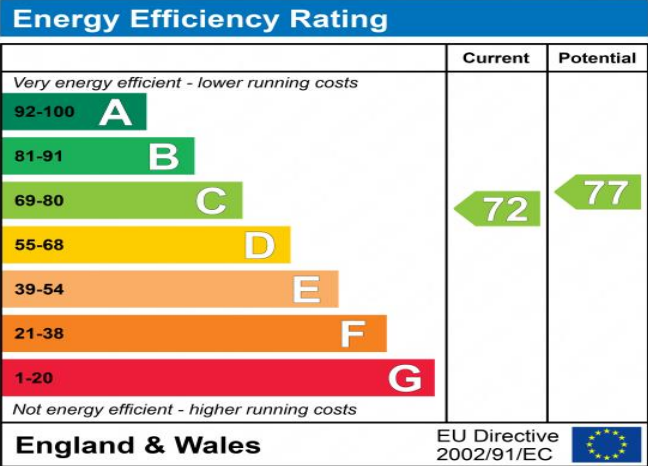

Lime Tree Court, Hatch End, HA5 4UX

Approximate Gross Internal Area = 74.3 sq m / 800 sq ft

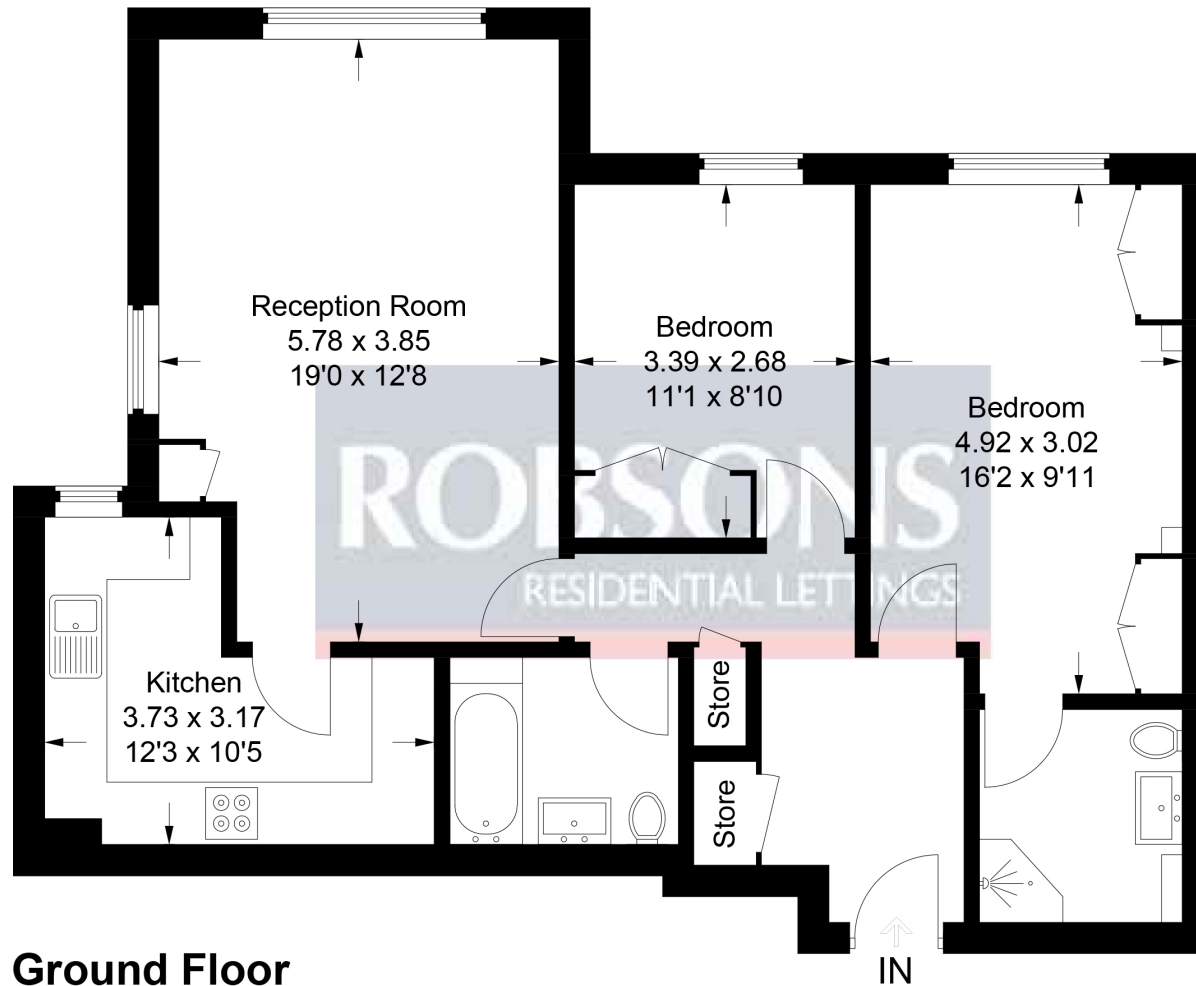

Ground Floor

This plan is for layout guidance only. Not drawn to scale unless stated. Windows and door openings are approximate. Whilst every care is taken in the preparation of this plan, please check all dimensions, shapes and compass bearings before making any decisions reliant upon them.

© CJ Property Marketing Ltd Produced for Robsons



REGISTERED OFFICE 2-4 PACKHORSE ROAD, GERRARDS CROSS, BUCKINGHAMSHIRE, ENGLAND, SL9 7QE. COMPANY NO. 07557114. VAT NO. GB211239453