

£2,175,000
Westerham Road
Keston, BR2 6AG



EPC RATING: D COUNCIL TAX BAND: G

Brambletye Westerham Road, Keston, BR2

Approximate Area = 2569 sq ft / 238.6 sq m (exclude tennis court)
 Garage = 158 sq ft / 14.6 sq m
 Outbuilding = 260 sq ft / 24.1 sq m
 Total = 2987 sq ft / 277.4 sq m
 For identification only - Not to scale

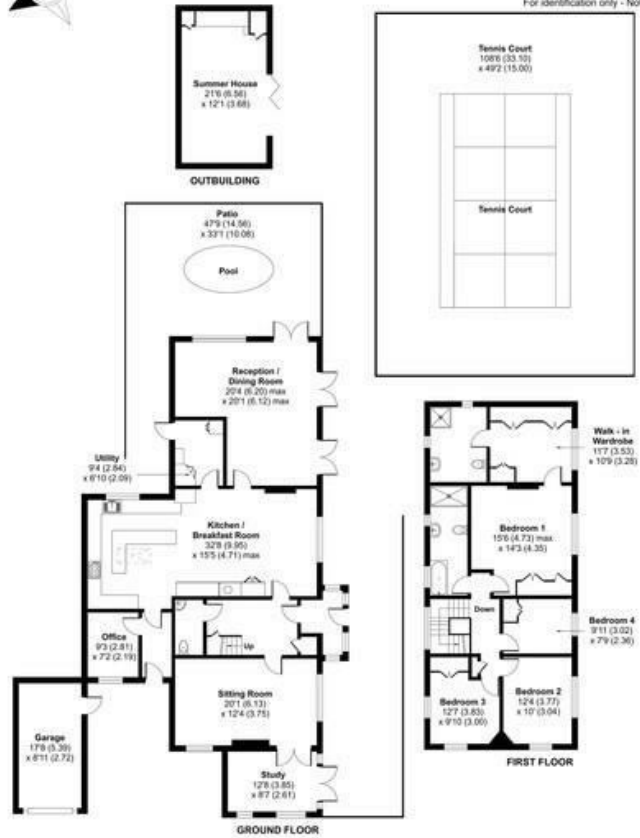

Floor plan produced in accordance with RICS Property Measurement 2nd Edition, incorporating International Property Measurement Standards (IPMS Residential). © richcom-2021. Produced for Langford Russell - REP: 1266291



Energy Efficiency Rating		Current	Potential
Very energy efficient - lower running costs			
(92 plus) A			
(81-91) B			
(69-80) C			
(55-68) D		67	79
(39-54) E			
(21-38) F			
(1-20) G			
Not energy efficient - higher running costs			
England & Wales		EU Directive 2002/91/EC	

Agents Note: Whilst every care has been taken to prepare these particulars, they are for guidance purposes only. All measurements are approximate and are for general guidance purposes only and whilst every care has been taken to ensure their accuracy, they should not be relied upon and potential buyers/tenants are advised to recheck the measurements



OFFICE ADDRESS
 57 Station Approach
 Hayes
 Kent
 BR2 7EB

OFFICE DETAILS
 020 8462 0360
 infohy@sinclairhammelton.co.uk
<https://www.sinclairhammelton.co.uk>
 for-sale-in-hayes/