



7a Cliff Street, £240,000

- COUNCIL TAX BAND - C
- NO CHAIN
- VERSATILE ATTIC/LOFT ROOM
- CLOSE TO SEAFRONT AND PENARTH MARINA
- CLOSE TO TOWN CENTER
- CLOSE TO TRANSPORT LINKS
- EPC Rating: D



 2  1  2



About the property

Offered with no chain Situated on the sought-after Cliff Street, this charming two-bedroom end-terrace home is ideally located in the heart of Penarth, just a short walk from local shops, cafés, excellent transport links and the seafront.

Accommodation

Entrance Hallway

A welcoming entrance hallway providing access to the ground floor accommodation and staircase rising to the first floor.

Lounge

11' 9" max x 9' 2" max (3.58m max x 2.79m max)

A bright and welcoming living room situated to the front of the property, featuring a large window that allows plenty of natural light to flood the space.

Kitchen

11' 9" max x 10' 4" max (3.58m max x 3.15m max)

A well-appointed kitchen fitted with a range of wall and base units, complemented by work surfaces and space for essential appliances.

Shower Room



8' 2" max x 8' 2" max (2.49m max x 2.49m max)

shower room fitted with a walk-in shower enclosure, wash hand basin and low-level WC

Landing

Providing access to both bedrooms, and stairs leading to the second-floor attic room.

Bedroom 1

10' 10" max x 10' 2" max (3.30m max x 3.10m max)

A generously sized double bedroom overlooking the rear garden, offering ample space for freestanding furniture and benefiting from an abundance of natural light.

Bedroom 2

10' 8" max x 9' 8" max (3.25m max x 2.95m max)

A well-proportioned second bedroom, ideal as a guest room, children's bedroom or home office.

Attic Room

13' 1" max x 9' 10" max (3.99m max x 3.00m max)

Situated on the second floor, this versatile attic room offers a bright and spacious additional living area. Benefiting from a Velux window that floods the space with natural light, the room is ideal for use as a home office, hobby room, occasional guest room or study

02920 703799

penarth@peteralan.co.uk

Floorplan

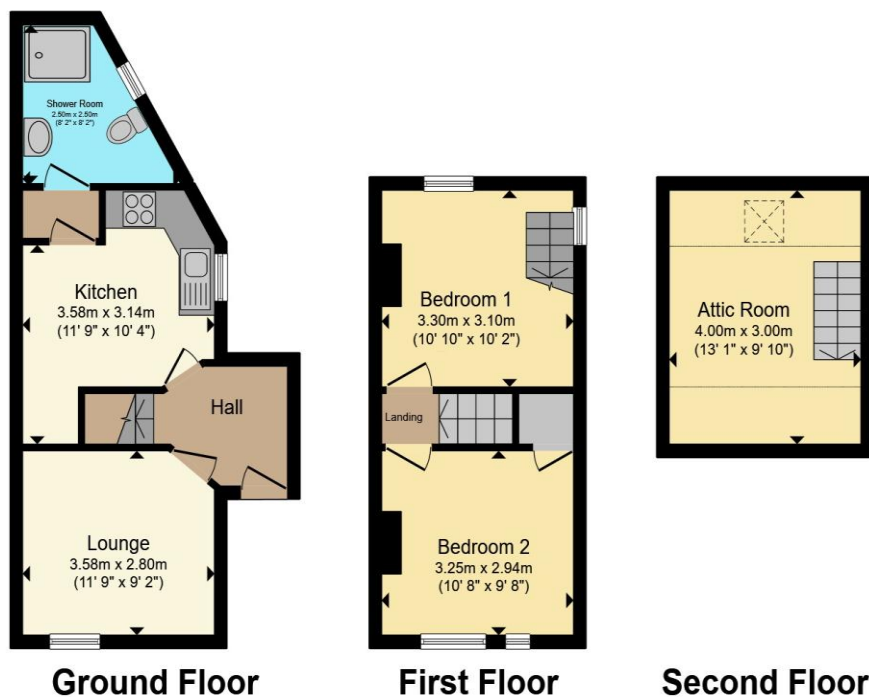

Total floor area 65.8 m² (708 sq.ft.) approx

This floor plan is for illustrative purposes only. It is not drawn to scale. Any measurements, floor areas (including any total floor area), openings and orientation are approximate. No details are guaranteed, they cannot be relied upon for any purpose and they do not form part of any agreement. No liability is taken for any error, omission or misstatement. A party must rely upon its own inspection(s). Powered by www.propertybox.io

Important Information

Note while we endeavour to make our sales details accurate and reliable, if there is any point which is of particular interest to you, please contact the office and we will be pleased to confirm the position for you. We have not personally tested any apparatus, equipment, fixtures, fittings or services and cannot verify they are in working order or fit for their purposes. Nothing in these particulars is intended to indicate that carpets or curtains, furnishings or fittings, electrical goods (whether wired or not). Gas fires or light fittings or any other fixtures not expressly included form part of the property offered for sale. This computer generated Floorplan, if applicable, is intended as a general guide to the layout and design of the property. It is not to scale and should not be relied upon for dimensions. Tenure: We cannot confirm the tenure of the property as we have not had access to the legal documents. The buyer is advised to obtain verification from their solicitor or surveyor.

Peter Alan Limited is registered in England and Wales under company number 2073153, Registered Office is Cumbria House, 16-20 Hockliffe Street, Leighton Buzzard, Bedfordshire, LU7 1GN. VAT Registration Number is 500 2481 05. For activities relating to regulated mortgages and non-investment insurance contracts, Peter Alan Limited is an appointed representative of Connells Limited which is authorised and regulated by the Financial Conduct Authority. Connells Limited's Financial Services Register number is 302221. Most buy-to-let