



£265,000

*At a glance...*



2



1



2



EPC

B



COUNCIL  
TAX

C

**holland  
& odam**

3 Elaina Close  
Street  
Somerset  
BA16 0GY

**TO VIEW**

3 Farm Road, Street,  
Somerset BA16 0BJ

**01458 841411**

[street@hollandandodam.co.uk](mailto:street@hollandandodam.co.uk)



## Directions

From the town centre proceed in a westerly direction passing Living Homes on the right (corner of Orchard Road) and take the next turning on the right into Cranhill Road. Pass the turning for Oxendale and take the next left into Elaina Close. Where the property will be identified by our For Sale board.

## Services

Mains electricity, gas, water and drainage are connected. Gas central heating system.

## Local Authority

Somerset Council  
0300 1232224  
[somerset.gov.uk](http://somerset.gov.uk)

## Tenure

Freehold



## Location

The property is conveniently situated being a short walk from the High Street enjoying an excellent range of shops, cafes and restaurants and Clarks Village with its wide range of shopping outlets. Street also has the benefit of both indoor and open air swimming pools, Strode College and Victoria sports club. The historic town of Glastonbury is 2 miles and the Cathedral City of Wells 8 miles. Access to the M5 motorway can be gained at junction 23 (Dunball) some 12 miles distant whilst Bristol, Bath, Taunton and Exeter are all within commuting distance.

## Insight

Tucked away in the corner of a quiet cul-de-sac, just a stone's throw from the High Street and Clarks Village, is this immaculately presented two-bedroom semi-detached home. Beautifully maintained and ready to move straight into, the property is well appointed and tastefully decorated throughout, benefiting from allocated parking and a desirable south-west facing garden. Offered to the market with no onward chain.

- Generous open-plan living space offering ample room for both lounge and dining furniture, with French doors opening directly onto the garden.
- Stylish kitchen featuring a comprehensive range of contemporary wall, base and drawer units, a built-in oven and hob, along with integrated appliances including a washing machine, fridge and freezer.
- Offering two bedrooms arranged over two floors, including a well-proportioned principal bedroom benefiting from its own en suite shower room.
- Additional ground floor shower room finished in a stylish, modern design, ideal for guests and everyday convenience.
- Desirable south-west facing garden designed for ease of maintenance, featuring a patio area, lawn edged by a herbaceous border, and a useful garden shed.
- Benefiting from one allocated parking space, with a decorative gravelled frontage providing an attractive and low-maintenance approach to the property.



GROUND FLOOR  
463 sq.ft. (43.0 sq.m.) approx.

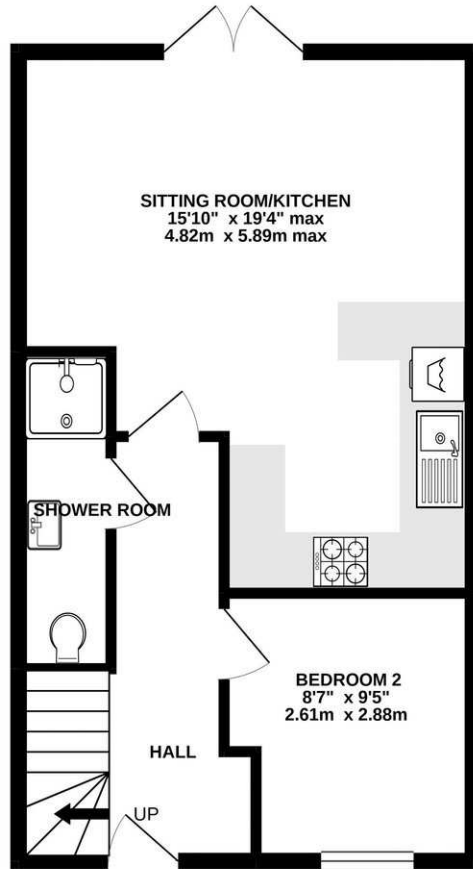

1ST FLOOR  
463 sq.ft. (43.0 sq.m.) approx.



TOTAL FLOOR AREA : 926 sq.ft. (86.0 sq.m.) approx.

Whilst every attempt has been made to ensure the accuracy of the floorplan contained here, measurements of doors, windows, rooms and any other items are approximate and no responsibility is taken for any error, omission or mis-statement. This plan is for illustrative purposes only and should be used as such by any prospective purchaser. The services, systems and appliances shown have not been tested and no guarantee as to their operability or efficiency can be given.  
Made with Metropix ©2020

**DISCLAIMER**

CONSUMER PROTECTION FROM UNFAIR TRADING REGULATIONS 2008. The Agent has not tested any apparatus, equipment, fixtures and fittings or services and so cannot verify that they are in working order or fit for the purpose. A Buyer is advised to obtain verification from their Solicitor or Surveyor. References to the Tenure of a Property are based on information supplied by the Seller. The Agent has not had sight of the

title documents. A Buyer is advised to obtain verification from their Solicitor. Items shown in photographs are not included unless specifically mentioned within the sales particulars. They may however be available by separate negotiation. Buyers must check the availability of any property and make an appointment to view before embarking on any journey to see a property.

DATA PROTECTION. Personal information provided by customers wishing to receive information and/or services from the estate agent and the Property Sharing Experts (of which it is a member) for the purpose of providing services associated with the business of an estate agent but specifically excluding mailing or promotions by a third party. If you do not wish your personal information to be used for any of these purposes, please notify us.