



MILE



North End Road, London £1,350 pcm %tenure%

Mile are pleased to offer this stunning Super Bedsit to rent! The property consists of a large L Shaped studio room with a Private fully fitted kitchen! Located in the HEART OF GOLDERS GREEN - right OPPOSITE THE TUBE STATION!!!. Finished to a high standard. Available 21st April 2026. MUST BE SEEN TO AVOID DISSAPPOINTMENT! EPC RATING D

ALL BILLS INCLUDED (INC COUNCIL TAX AND INTERNET)

- Stunning Super bedsit
- AMAZING LOCATION
- Opposite Golders Green Station
- MUST BE SEEN!!
- high Spec Finish
- Available 21st April
- Modern
- Fully Fitted Kitchen
- EPC Rating D
-

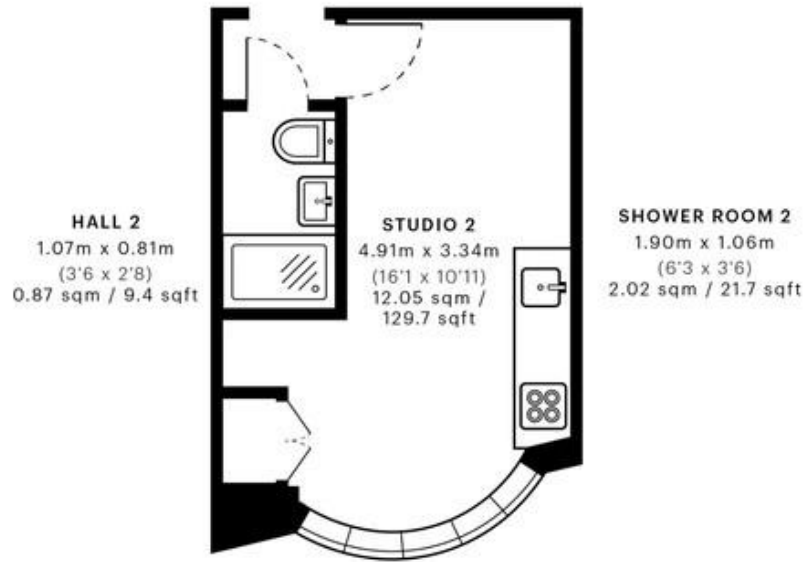

— First Floor

	<p>GROSS INTERNAL AREA (GIA) The footprint of the property</p> <p>15.51 sqm / 166.95 sqft</p>		<p>NET INTERNAL AREA (NIA) Excludes walls and external features Includes washrooms, restricted head height</p> <p>14.94 sqm / 160.81 sqft</p>		<p>EXTERNAL STRUCTURAL FEATURES Balconies, terraces, verandas etc.</p> <p>0.00 sqm / 0.00 sqft</p>		<p>RESTRICTED HEAD HEIGHT Limited use area under 1.5 m</p> <p>0.00 sqm / 0.00 sqft</p>
--	--	---	--	---	---	---	---

Spec Verified floor plans are produced in accordance with

IPMS 38 RESIDENTIAL 15.93 sqm / 171.47 sqft

MONEY LAUNDERING REGULATIONS 2003: Intending purchasers will be asked to produce identification documentation at a later stage and we would ask for your co-operation in order that there will be no delay in agreeing the sale.

General: While we endeavour to make our sales particulars fair, accurate and reliable, they are only a general guide to the property and, accordingly, if there is any point which is of particular importance to you, please contact the office and we will be pleased to check the position for you, especially if you are contemplating travelling some distance to view the property.

Measurements: These approximate room sizes are only intended as general guidance. You must verify the dimensions carefully before ordering carpets or any built-in furniture.

Services: Please note we have not tested the services or any of the equipment or appliances in this property, accordingly we strongly advise prospective buyers to commission their own survey or service reports before finalising their offer to purchase.