

BRENNAN

BESPOKE

£200,000
Leicester Street
Kettering, NN16 8EF

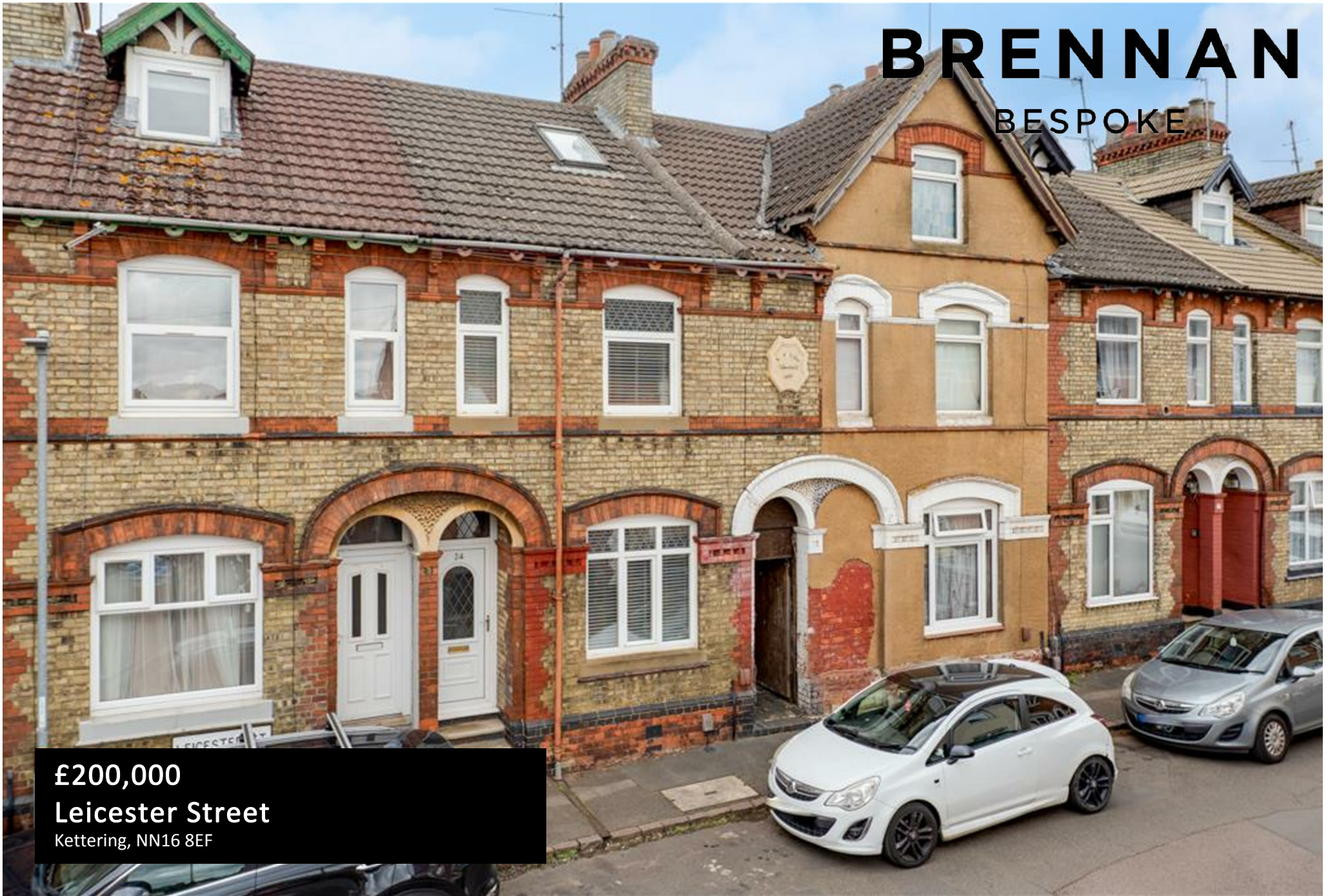

This three-bedroom Victorian terrace offers spacious and versatile accommodation arranged over three floors, making it an ideal purchase for families, first-time buyers, or investors alike. The ground floor comprises a welcoming lounge leading through to a generous dining room, creating an excellent space for both everyday living and entertaining. To the rear, the fitted kitchen provides ample storage and workspace, with access to the enclosed rear garden. The first floor offers two well-proportioned bedrooms together with a family bathroom, while the second floor offers a further double bedroom, complemented by useful eaves storage. Outside, the property benefits from an attractive and well-maintained rear garden featuring a lawned area, patio seating space and established borders, providing a private setting for outdoor relaxation and entertaining. Retaining much of its traditional character while offering practical modern living, this charming home enjoys a convenient location within easy reach of Kettering town centre, local schools, shops, amenities and transport links, including Kettering railway station with direct services to London. Early viewing is highly recommended to fully appreciate the space, character and lifestyle on offer.

3



1



2





BRENNAN
BESPOKE

OFFICE ADDRESS
BRENNAN BESPOKE
2 The Tithe Barn Glendon Lodge Farm
Glendon
Kettering
Northamptonshire
NN14 1QF

OFFICE DETAILS
01536 904400
info@brennanbespoke.co.uk
<https://www.brennanbespoke.co.uk>

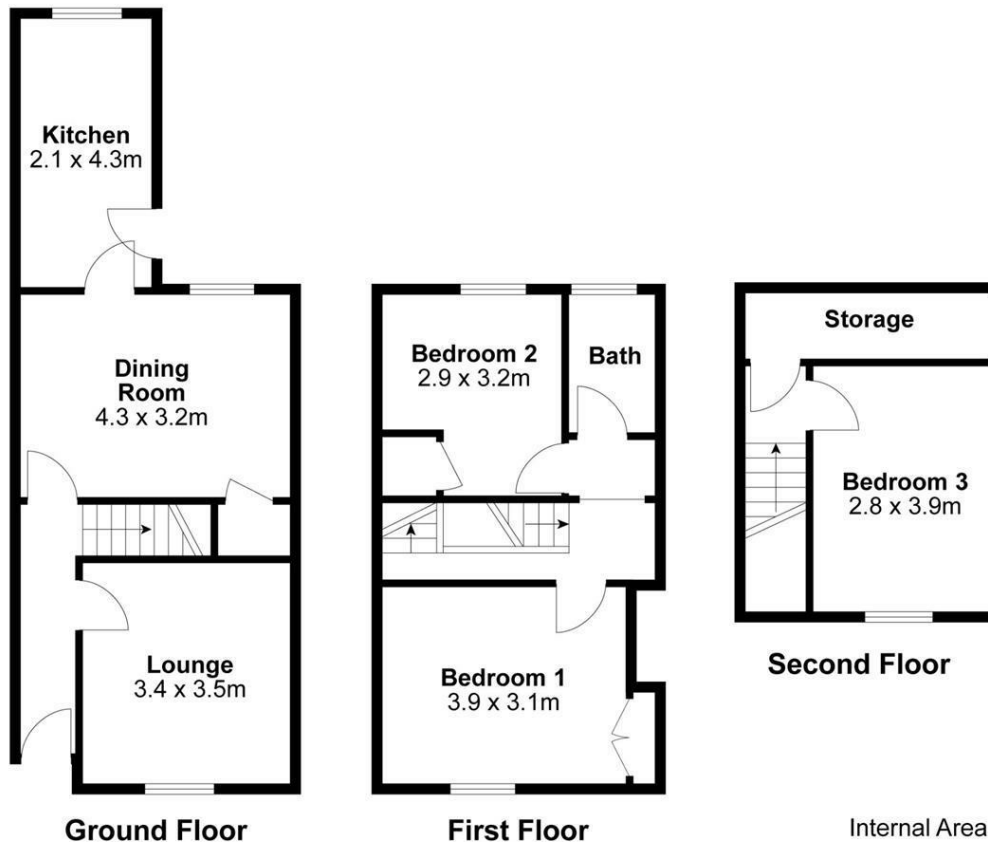

For identification only not to scale

Internal Area Approx. : 999 ft²

BRENNAN
BESPOKE

LOCAL AUTHORITY
North Northamptonshire

TENURE
Freehold

COUNCIL TAX BAND
A

VIEWINGS
By prior appointment only

Energy Efficiency Rating		Current	Potential
<i>Very energy efficient - lower running costs</i>			
(92 plus) A			
(81-91) B			83
(69-80) C		69	
(55-68) D			
(39-54) E			
(21-38) F			
(1-20) G			
<i>Not energy efficient - higher running costs</i>			
England & Wales		EU Directive 2002/91/EC	

Agents Note: Whilst every care has been taken to prepare these particulars, they are for guidance purposes only. All measurements are approximate and are for general guidance purposes only and whilst every care has been taken to ensure their accuracy, they should not be relied upon and potential buyers/tenants are advised to recheck the measurements