



CUMBERLAND MARKET, NW1

£540,000

Three bedrooms
Over 800 sq ft
Private balcony
Close to Euston & Regents Park
Good condition
Quiet location

@marshandparsons
marshandparsons.co.uk

MARSH &
PARSONS



ABOUT THE PROPERTY

This superb, three-bedroom apartment is situated on the first floor of a low rise, purpose built block comprising a large, reception with private balcony, separate kitchen, bathroom with separate WC and three great sized bedrooms.

Cumberland Market is ideally located near Regent's Park, with Camden, Marylebone, and the West End nearby. It offers excellent transport links via Euston, Warren Street, Regent's Park, King's Cross, and numerous bus routes.



STEP INSIDE CUMBERLAND MARKET

Grisedale, Cumberland Market, NW1

APPROX. GROSS INTERNAL FLOOR AREA 808 SQFT / 75.06 SQM

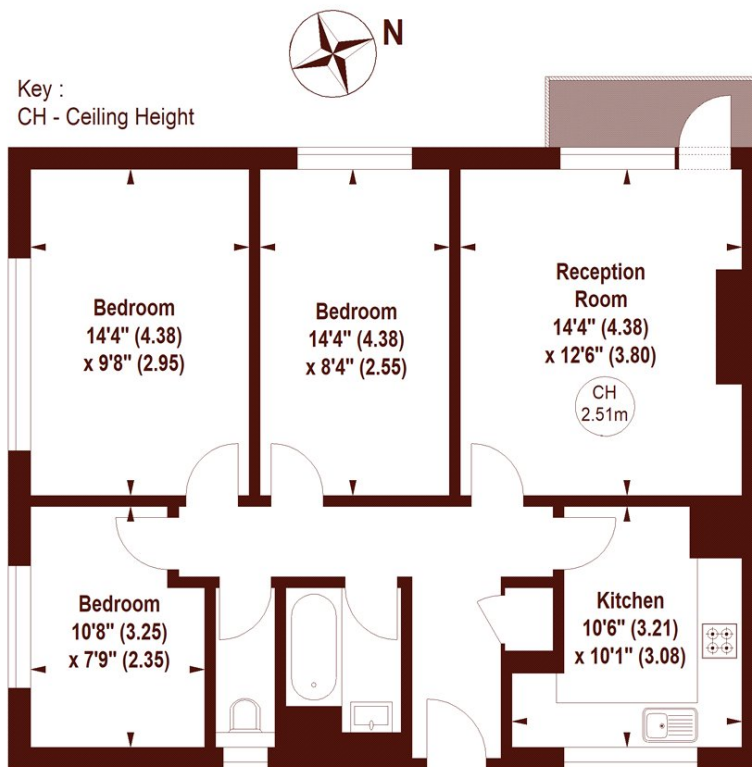

FIRST FLOOR

Not to scale, for guidance only and must not be relied upon as a statement of fact.
All measurements and areas are approximate only

Camden
020 7244 2200

Energy Rating: We aim to make our particulars both accurate and reliable. However, they are not guaranteed; nor do they form part of an offer or contract. If you require clarification on any points then please contact us, especially if you're traveling some distance to view. Please note that appliances and heating systems have not been tested and therefore no warranties can be given as to their good working order

MARSH &
PARSONS