



Connells

Tottehale Close
North Baddesley Southampton

Tottehale Close North Baddesley Southampton SO52 9NQ

for sale
£225,000



Property Description

This well-presented home is positioned in the popular village of North Baddesley, a friendly and well-connected community offering shops, pubs, a post office, green spaces and excellent schools. Property benefits from a front driveway accessed via drop kerb as well as an additional parking space allocated to the property. Inside, the property features a bright lounge with a bay window and wood flooring, a modernised kitchen with new white goods and updated electrics, and a generous double bedroom with fitted wardrobes. The bathroom includes a heated towel rail, bath and built-in storage. North Baddesley provides easy access to Southampton, Romsey and the M27, plus local parks, sports facilities and beautiful surrounding countryside, making it ideal for both convenience and outdoor enjoyment

Entrance Porch

Useful entrance space with built-in storage cupboard housing the property's electrical point.

Lounge

13' 7" x 10' 7" (4.14m x 3.23m)

Bright front-aspect room with bay window, wood flooring, radiator and a built-in understairs cupboard.

Kitchen

13' 7" x 5' 2" (4.14m x 1.57m)

Well-equipped kitchen with wall, base and drawer units, roll-top work surfaces, localised

tiling, space for oven, fridge freezer and dishwasher. Includes new white goods, new sink, extractor, updated electrical points, inset lighting and a double-glazed window to the front.

Landing

Loft hatch providing additional storage access.

Bedroom One

11' 6" x 10' (3.51m x 3.05m)

A generous double room featuring built-in wardrobes, a cupboard housing the water tank, and LVT flooring.

Bathroom

Fitted with bath, WC, basin, heated towel rail, localised tiling, tiled flooring, inset lighting and a built-in storage cupboard.







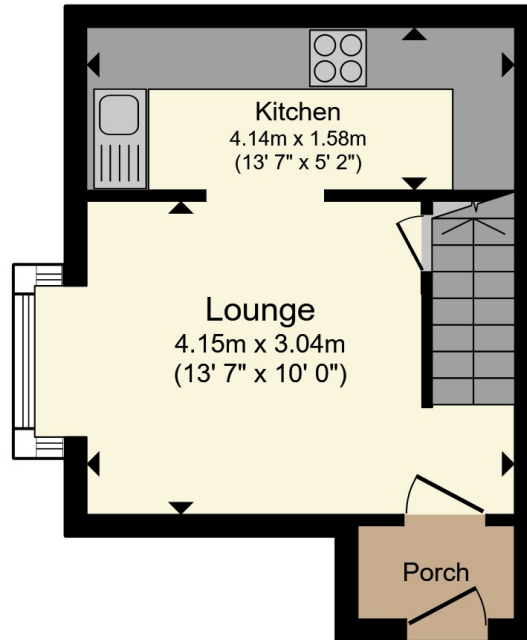

Ground Floor

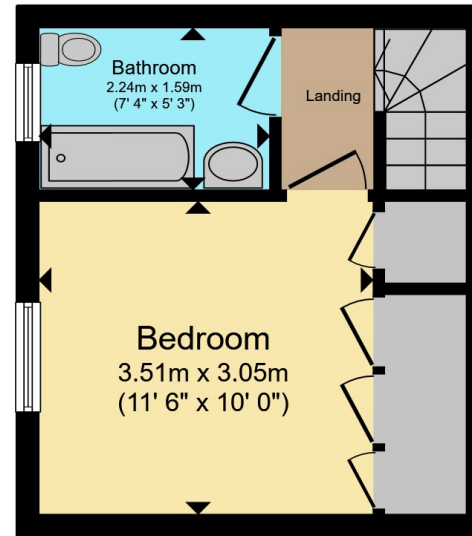

First Floor

Total floor area 41.3 m² (445 sq.ft.) approx

This floor plan is for illustrative purposes only. It is not drawn to scale. Any measurements, floor areas (including any total floor area), openings and orientation are approximate. No details are guaranteed, they cannot be relied upon for any purpose and they do not form part of any agreement. No liability is taken for any error, omission or misstatement. A party must rely upon its own inspection(s). Powered by www.propertybox.io



To view this property please contact Connells on

T 01794 830 833
E romsey@connells.co.uk

13a The Hundred
 ROMSEY SO51 8GD

EPC Rating: C Council Tax
 Band: B

Tenure: Freehold

view this property online connells.co.uk/Property/ROM307025



1. MONEY LAUNDERING REGULATIONS Intending purchasers will be asked to produce identification documentation at a later stage and we would ask for your co-operation in order that there will be no delay in agreeing the sale. 2. These particulars do not constitute part or all of an offer or contract. 3. The measurements indicated are supplied for guidance only and as such must be considered incorrect. Potential buyers are advised to recheck measurements before committing to any expense. 4. We have not tested any apparatus, equipment, fixtures, fittings or services and it is in the buyers interest to check the working condition of any appliances.

Connells Residential is registered in England and Wales under company number 1489613, Registered Office is Cumbria House, 16-20 Hockliffe Street, Leighton Buzzard, Bedfordshire, LU7 1GN. VAT Registration Number is 500 2481 05.

See all our properties at www.connells.co.uk | www.rightmove.co.uk | www.zoopla.co.uk

Property Ref: ROM307025 - 0005