



## Hayter Road, SW2

£2,500 Per calendar month

A raised ground floor period conversion presented in good order throughout, comprising a spacious reception room with a separate kitchen and doors that open on to a private balcony, two double bedrooms and a bathroom.

A residential street popular for its close proximity to the many superb shops, restaurants and bars of both Brixton and Clapham Town centres. The green open spaces of Brockwell Park are close by, along with excellent transport links into the City.

### Features

Raised Ground Floor  
Two Double Bedrooms  
Period Conversion

Separate Kitchen  
Private Balcony

Hayter Road,  
London, SW2

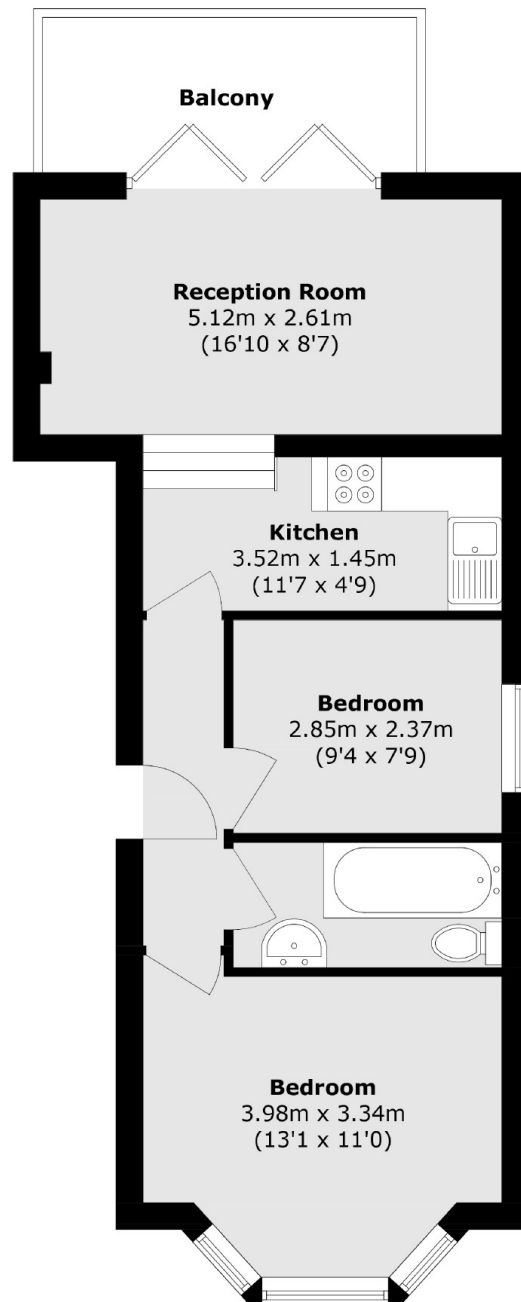

Total area (approx.): 49.1 sq. m (528.5 sq. ft)  
Balcony area (approx.): 7.1 sq. m (76.4 sq. ft)