



House - Terraced

2 CHANTRY LANE,
TOWCESTER,
TOWCESTER,
NORTHAMPTONSHIRE,
NN12 6YY

PCM

£1,350 PCM

FEATURES

- Mid Terraced Stone Built Home
- Gas Fired Central Heating
- Kitchen/Diner
- Built in wardrobes
- All Rooms Of Irregular Shape
- Hallway, Cloakroom, Sitting Room
- Three Bedrooms
- Small Courtyard, Allocated Parking



HOWKINS &
HARRISON

3 Bedroom House - Terraced located in Towcester

Call us on

01327 359164

towcesterletts@howkinsandharrison.co.uk

Howkins & Harrison are pleased to offer for let this modern mid terrace three-bedroom house located in a prime central location, just a few yards from local amenities and open countryside walks.

The accommodation is finished to a high specification, built by Clayton Country Homes, the property features a contemporary cloakroom and family bathroom, fabulous, fitted kitchen with high gloss units, Onyx worktops and fitted appliances including an oven and hob, an integrated fridge/freezer and both dishwasher and washing machine. The centrally heated accommodation further benefits from an Oak floor in the sitting room and fitted wardrobes in two of the bedrooms. Outside is a small courtyard and gated access to private parking for one vehicle. Offered Unfurnished, Available Immediately, EPC Rating B.

TOWCESTER is a thriving town centred on the historic Market Square, where there are shopping and other facilities. Towcester is situated on the junction of the A5 Watling Street and the A43 Oxford to Northampton Road. The A43 provides the town with an excellent high speed road link to Northampton, the M1 and the M40. Milton Keynes with its Inter-city rail service (London Euston 40 minutes) is approximately 12 miles to the south. Sporting facilities in the area include a Leisure Centre, motor racing at Silverstone and golf at Farthingstone, Silverstone and Whittlebury. There are also churches of several denominations in the town.

Council Tax Band

C

Approx Gross Internal Area
82 sq m / 882 sq ft

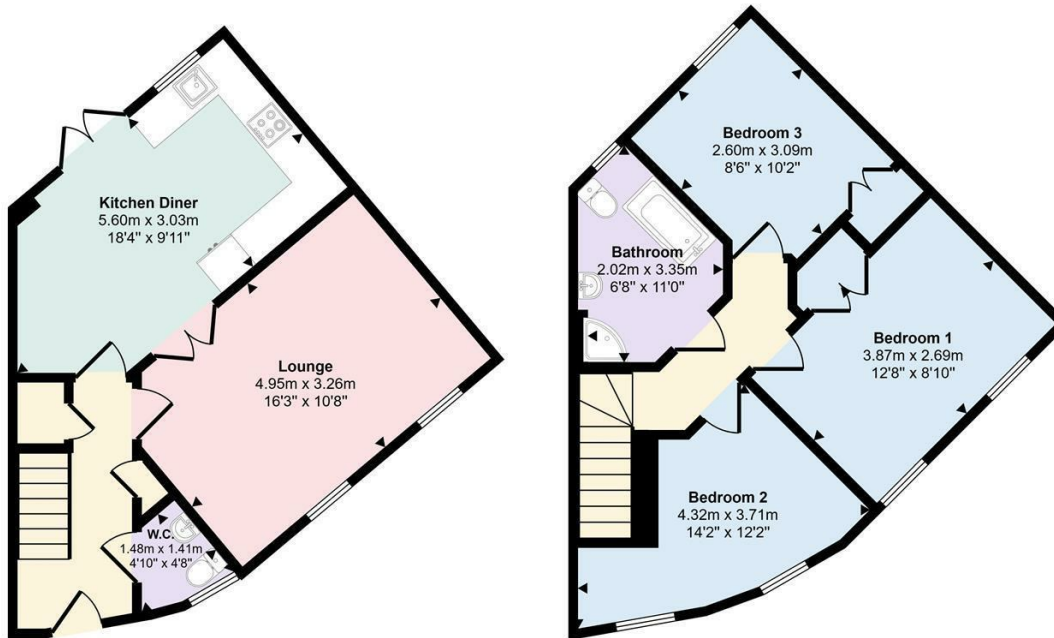

Ground Floor
Approx 41 sq m / 439 sq ft

First Floor
Approx 41 sq m / 443 sq ft

This floorplan is only for illustrative purposes and is not to scale. Measurements of rooms, doors, windows, and any items are approximate and no responsibility is taken for any error, omission or mis-statement. Icons of items such as bathroom suites are representations only and may not look like the real items. Made with Made Snappy 360.

Energy Efficiency Rating		Current	Potential
<i>Very energy efficient - lower running costs</i>			
(92 plus) A			96
(81-91) B		85	
(69-80) C			
(55-68) D			
(39-54) E			
(21-38) F			
(1-20) G			
<i>Not energy efficient - higher running costs</i>			
England & Wales		EU Directive 2002/91/EC	

Agents Note: Whilst every care has been taken to prepare these particulars, they are for guidance purposes only. All measurements are approximate and are for general guidance purposes only and whilst every care has been taken to ensure their accuracy, they should not be relied upon and potential buyers are advised to recheck the measurements.

**HOWKINS &
HARRISON**