



### OFFICE HOURS:

Monday to Friday	9 am	to	5 pm
Saturday	9 am	to	2 pm
Sunday and Bank Holidays	12 noon	to	2 pm

## 10 good reasons to choose DMA

- \* Open 7 days a week.
- \* Filey's longest established family run independent estate agency.
- \* Prompt efficient friendly service.
- \* 360° virtual tours and floor plans.
- \* Free advertising: no sale - no charge.
- \* Free no obligation market valuation.
- \* Free accompanied viewing.
- \* Dedicated sales progression.
- \* Prominent town centre location.
- \* Modern walk-round self selection display.

RESIDENTIAL  
SALES

**DMA** ESTATE  
AGENTS

COMMERCIAL  
SALES



Proprietors: David Mansfield ATTON FNAEA.  
Samantha ADDISON  
[www.dmaestateagents.co.uk](http://www.dmaestateagents.co.uk)  
ESTABLISHED 1992



These particulars are intended only to give a fair description of the property, as a guide to prospective buyers. Accordingly a) their accuracy is not guaranteed and neither DMA Estate Agents nor the vendor(s) accept any liability in respect of their contents; b) they do not constitute an offer or contract of sale, and c) any prospective purchaser should satisfy themselves by inspection or otherwise as to the correctness of any statement or information in these particulars.

# DMA

ESTATE  
AGENTS



'THE GABLES'  
68 MUSTON ROAD, FILEY YO14 0AL



Freehold £597,000

### FEATURES

- \* Very attractive double fronted four bedroom detached residence.
- \* Located in this much sought after main road position.
- \* The property offers excellent spacious accommodation.
- \* 'New' gas central heating to radiators.
- \* Upvc double glazing.
- \* Large entrance hall.
- \* Modern fitted breakfast kitchen.
- \* Two large reception rooms.
- \* Ensuite to master bedroom.
- \* Conservatory.
- \* Long gated driveway to brick and tiled garage with adjacent store.
- \* Large gardens to the front and rear.
- \* Viewing is very highly recommended.

### ACCOMMODATION IN BRIEF

GROUND FLOOR: Recessed Vestibule. Front Door to Entrance Hall. Lounge. Dining Room. Kitchen. Utility Room. Conservatory. Two Bedrooms. Bathroom. Separate WC.

FIRST FLOOR: Two Bedrooms (one with Ensuite WC and handbasin).

OUTSIDE: Electric gates. Front garden. Drive to garage. Rear garden.

26 Belle Vue Street, FILEY, North Yorks. YO14 9HY. Telephone: 01723 515527  
[www.dmaestateagents.co.uk](http://www.dmaestateagents.co.uk) / [www.rightmove.co.uk](http://www.rightmove.co.uk)

## Floor Plan:

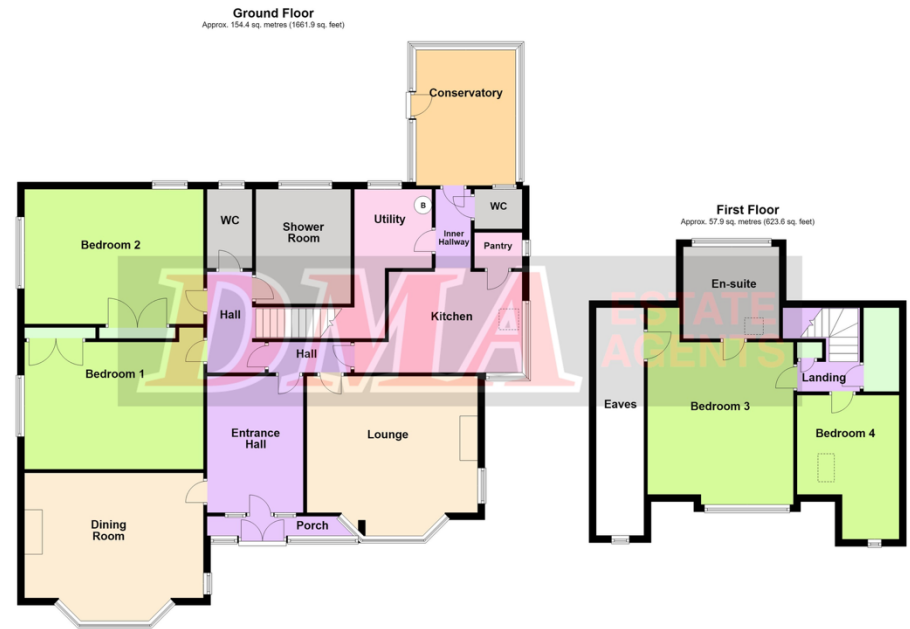

Total area: approx. 212.3 sq. metres (2285.4 sq. feet)

Please note this floor plan is only a guide and not to scale.  
Plan produced using PlanIt.

**68 Muston Road, Filey**

'THE GABLES', 68 MUSTON ROAD, FILEY

**RECESSED ENTRANCE VESTIBULE**

**Front Door to:**

**ENTRANCE HALL**

**3.84m x 2.69m (12'7" x 8'10")**

Oak panelling. Radiator. Delft rack. Feature original internal doors with leaded lights. Laminate flooring. 'Velux' window.



**DINING ROOM**

**5.03m x 4.22m (16'6" x 13'10")**

Gas log burner. Laminate flooring. Radiator. Upvc double glazed bay window. Two upvc double glazed side windows.



/ continued over

## LOUNGE

**4.80m x 4.06m** (15'9" x 13'4")

Black cast iron gas stove in brick surround with tiled back and hearth. Laminate flooring. Two radiators. Upvc double glazed bay window. Upvc double glazed side window.



## KITCHEN

**4.27m x 3.00m** (14'0" x 9'10")

Inset stainless steel sink, vegetable sink and drainer. Modern base cupboards with granite worktops over. Matching wall cupboards. Island. Five burner gas stove. Large walk-in pantry. Integrated dishwasher. Inset spotlights. 'Velux' window. Upvc double glazed window.



**Council Tax Band E.**

### DIRECTIONS:

From the DMA office follow the one-way system round turning left onto Station Avenue. Go straight across the roundabout and over the railway crossing onto Muston Road. The property is located on the right hand side.

**Viewing strictly by appointment only through DMA Estate Agents**

### ENSUITE

**2.69m x 2.56m** (8'10" x 8'9")

Bath. Quadrant shower cubicle. WC and handbasin. Extractor fan. Radiator. Upvc double glazed window.



### Access from Bedroom Three to LARGE WALK-IN LOFT

Feature porthole window.

### BEDROOM FOUR / STUDY

**2.49m x 2.44m** (8'2" x 8'0")

Feature porthole window. Radiator. Eaves storage. 'Velux' window.



### OUTSIDE:

Electric gates to front garden. Long drive to detached **brick GARAGE with tiled roof** and electric door **5.26m x 3.05m** (17'3" x 10'0") with **electric light and power**. Attached **brick STORE**. Large rear garden with lawn and borders. Patio and seating areas.

### UTILITY ROOM

**2.13m x 2.13m** (7'0" x 7'0")

Stainless steel sink and drainer. Modern base cupboards. Plumbing for automatic washing machine. New 'Viesmann' gas combination boiler to central heating. Upvc double glazed window.



### SEPARATE WC

**1.52m x 0.36m** (5'0" x 2'10")

Handbasin. Tiled walls. Radiator. Upvc double glazed window.

### CONSERVATORY

**3.81m x 2.79m** (12'6" x 9'2")

New glass roof. Electric heater. Upvc double glazed windows. **Upvc double glazed door to the garden.**



**BEDROOM ONE**

**4.27m x 3.15m** (14'10" x 10'4")

Fitted wardrobes. Radiator. Upvc double glazed window.



**BEDROOM TWO**

**4.27m x 3.78m** (14'0" x 12'5")

Built-in wardrobes. Two radiators. Two upvc double glazed windows.



**SHOWER ROOM**

**2.72m x 1.83m** (8'11" x 6'0")

Large walk-in shower. Handbasin and wc in vanity unit. Tiled walls. Ladder towel rail. Inset spotlights. Upvc double glazed window.



**SEPARATE WC**

Handbasin. Upvc double glazed window.



**INNER HALL**

Radiator.

**Stairs from Inner Hall to FIRST FLOOR:**

**LANDING**

Built-in cupboard. Linen cupboard.

**BEDROOM THREE**

**4.19m x 4.09m** (13'9" x 13'5")

Radiator. Upvc double glazed window.

